

APEX

APEX-WC: WELDED CEILING SYSTEM EXAMPLE SYSTEM

FEATURES:

- HEAVY DUTY, EXTRUDED ALUMINUM CEILING SYSTEM DESIGNED TO SUPPORT DIFFUSER, IN-FILL PANELS AND LIGHT FIXTURES IN A VARIETY OF CRITICAL ENVIRONMENTS
- FULLY CUSTOMIZABLE TO MATCH THE DEMANDING AND OFTEN CROWDED MODERN CLEANROOM CEILING LAYOUTS
- CONTINUOUS GASKET PREVENTS CONTAMINANT MIGRATION BETWEEN THE CEILING PLENUM AND OCCUPIED SPACE

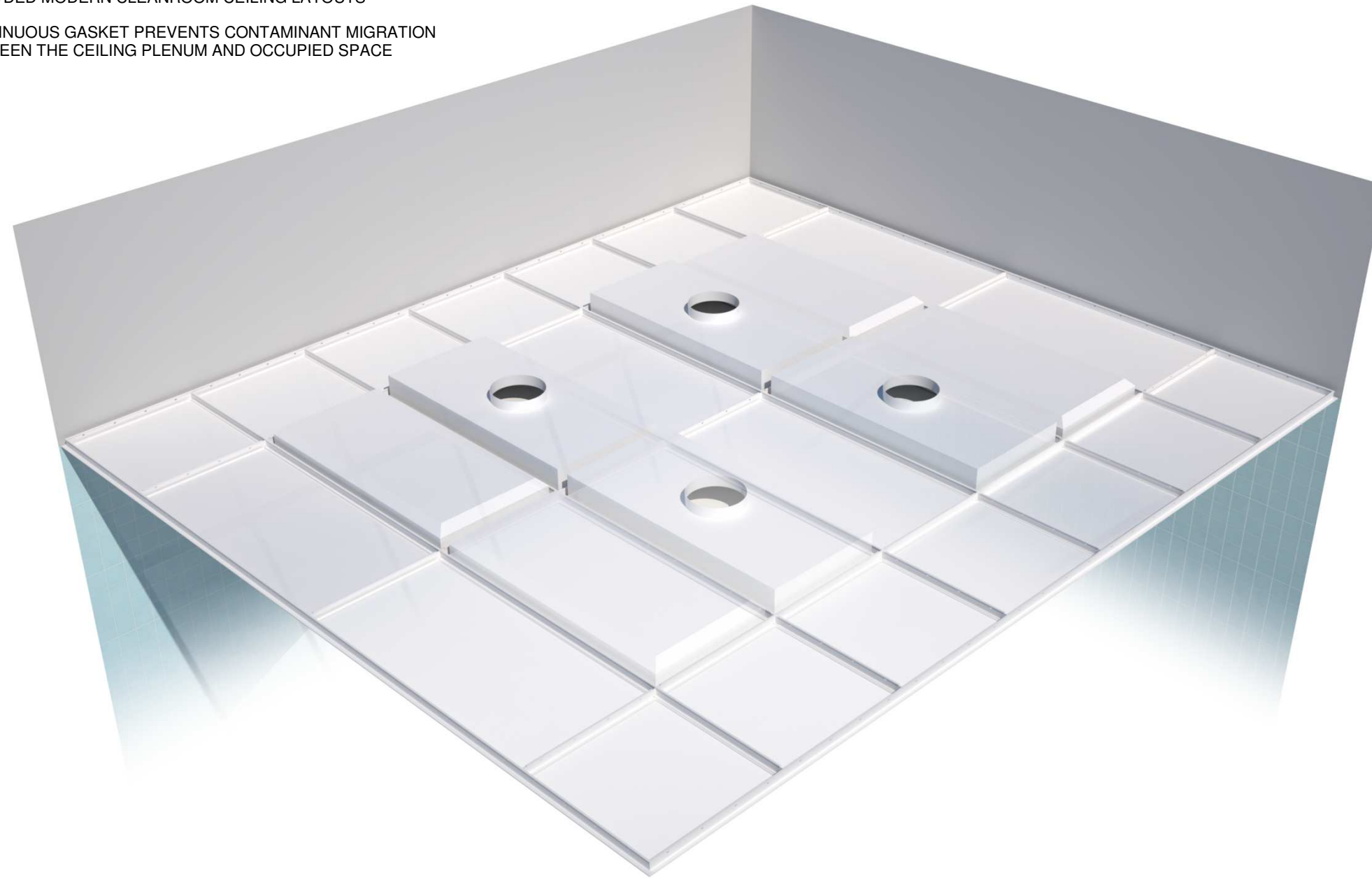

PROJECT:

274236

Revision: 0

03-22-2022

APEX-WC: WELDED CEILING SYSTEM
3D INTERACTIVE MODEL - SAMPLE LAYOUT

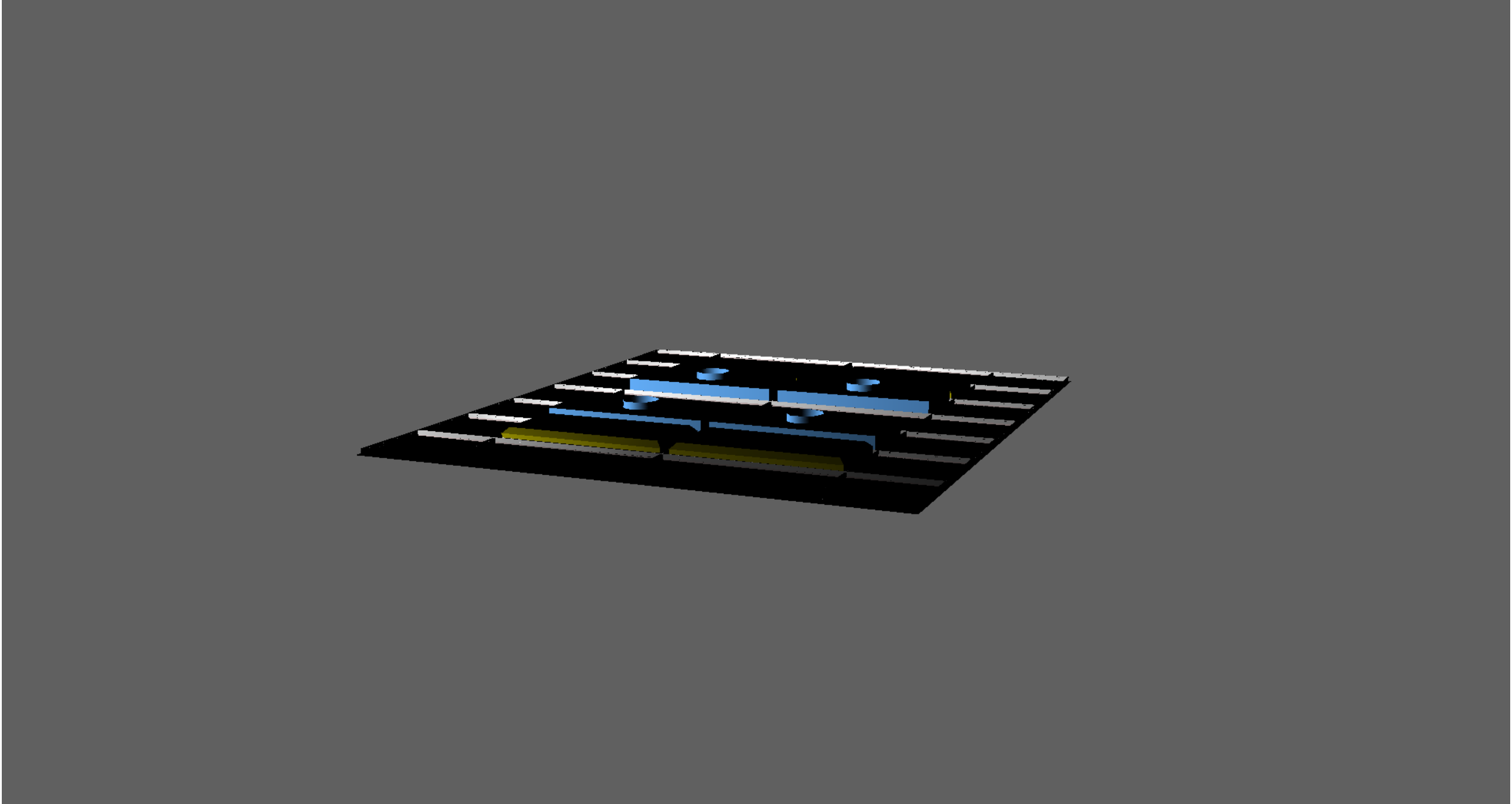

ORDER OF INSTALLATION
(CLICK BUTTONS TO TOGGLE VIEWS)

CLICK IMAGE TO
ACTIVATE 3D PDF





PROJECT:

274236	Revision: 0	03-22-2022
--------	-------------	------------

- USE THE SCROLL WHEEL TO ZOOM
- HOLD DOWN THE LEFT MOUSE BUTTON TO ROTATE
- HOLD DOWN CTRL AND LEFT MOUSE BUTTON TO MOVE

APEX

APEX-WC: WELDED CEILING SYSTEM
REFLECTED CEILING PLAN - SAMPLE LAYOUT

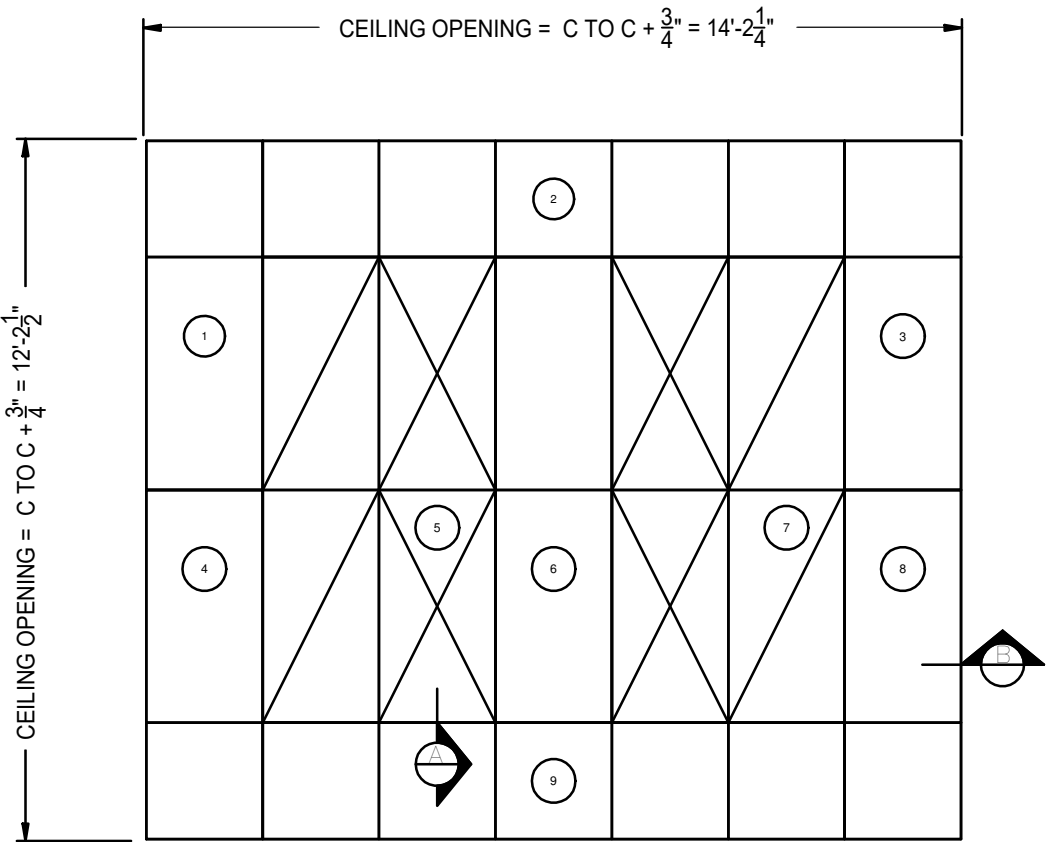

APEX-WC AREA = 172 sq. ft.

<input checked="" type="checkbox"/> DIFFUSERS	<input checked="" type="checkbox"/> LIGHT FIXTURES BY OTHERS	<input type="checkbox"/> SC - SOLID CORE ACCESS PANELS
24 x 48 (x 4)	24 x 48 (x 4)	A: 24 x 24 (x 14) B: 24 x 48 (x 6)

- B12 STANDARD WHITE FINISH
- PANEL CUTOUTS FOR BOOMS DONE IN FIELD BY OTHERS
- THE CEILING IS FACTORY PREMANUFACTURED TO SIZES AND TOLERANCE +/- 1/16"
- SITE ADJUSTMENTS TO PERIMETER SOFFITS AND/OR DRYWALL MAY BE REQUIRED AND ARE THE RESPONSIBILITY OF THE INSTALLER

PROJECT:

274236

Revision: 0

03-22-2022

APEX

APEX-WC: WELDED CEILING SYSTEM
SHIP SECTION BREAKDOWN - SAMPLE LAYOUT

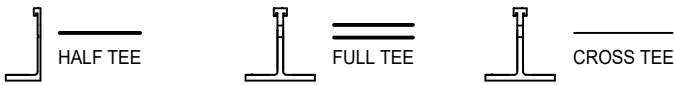
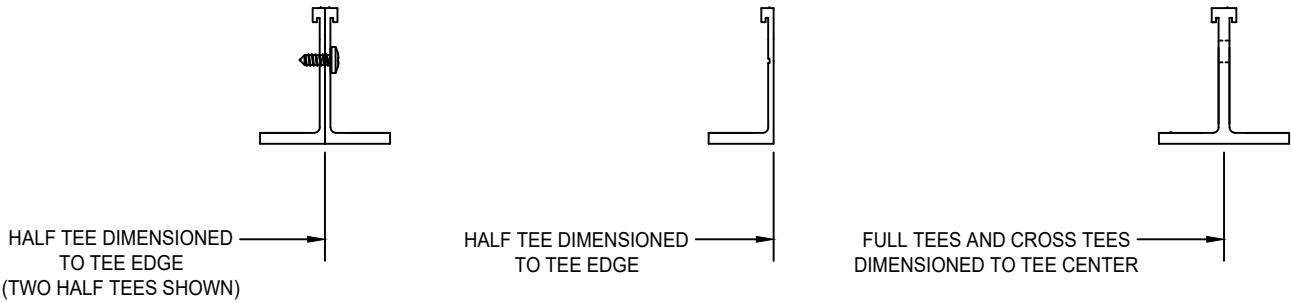
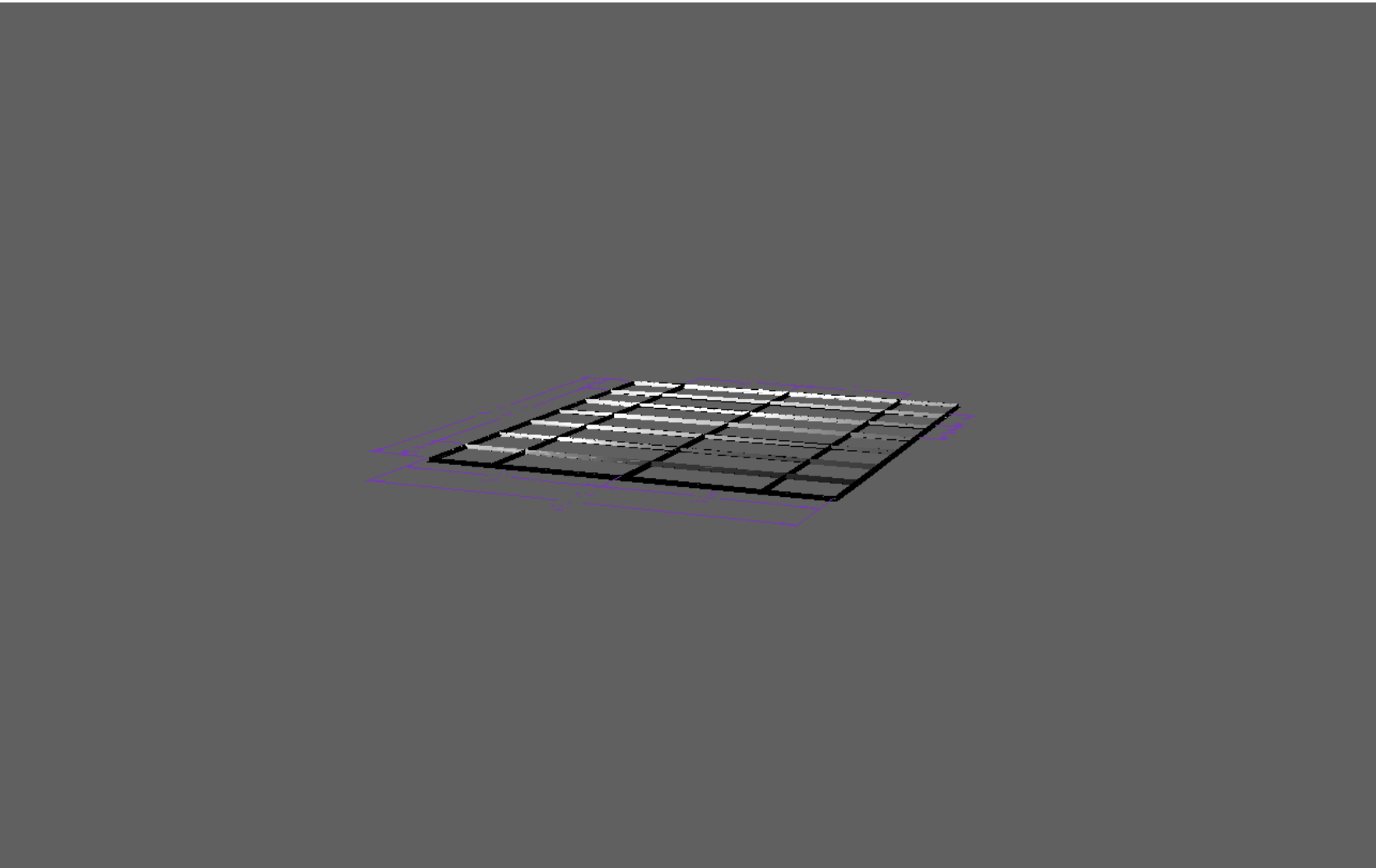
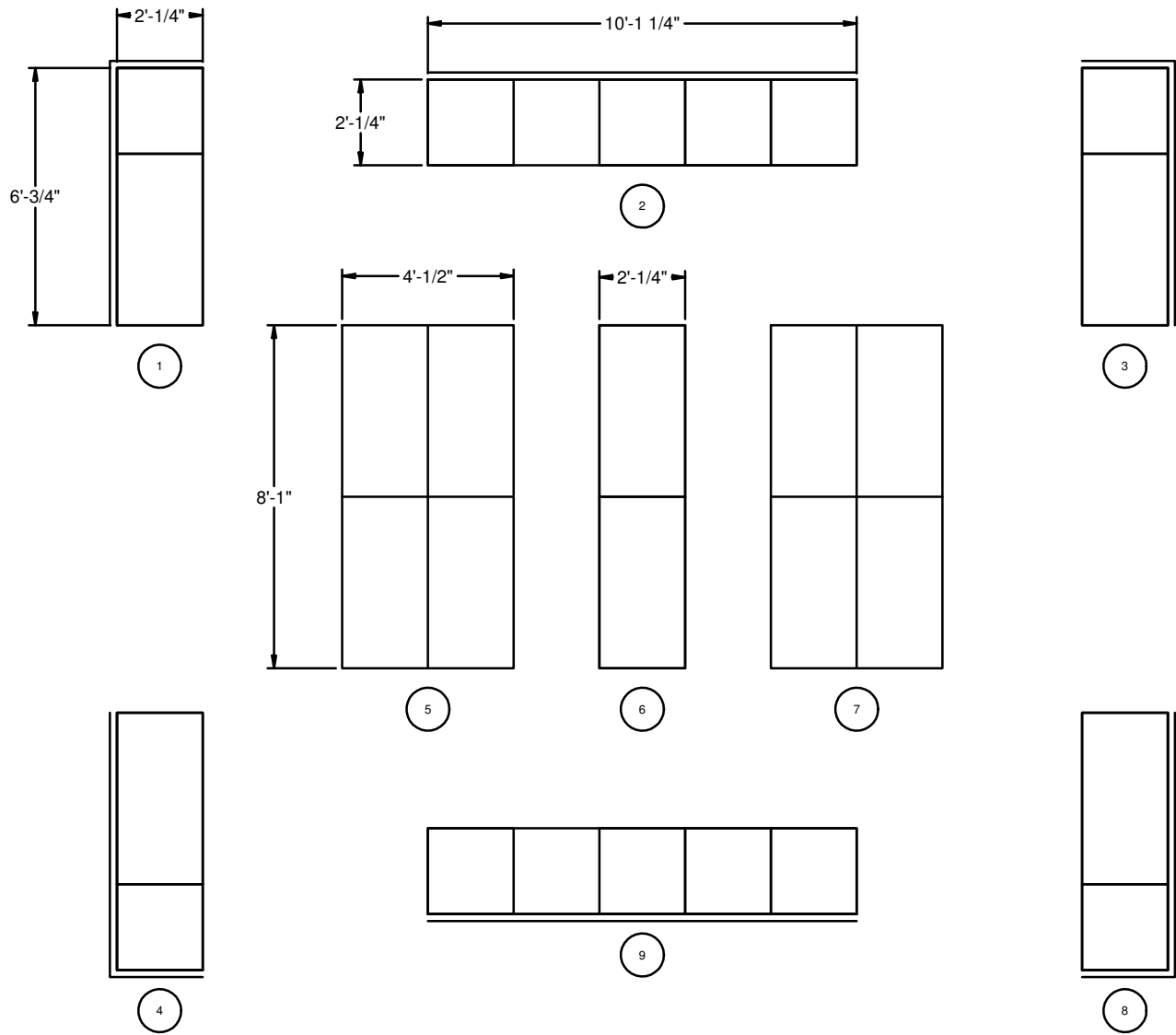

- THE APEX-WC GRID IS SUPPLIED IN MULTIPLE FACTORY ASSEMBLED SECTIONS NO LARGER THAN 10'x4'
- THE CEILING IS FACTORY PRE-MANUFACTURED TO SIZES AND TOLERANCE 1/- 1/16"

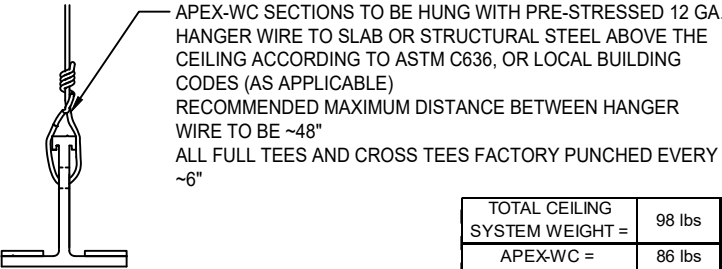

APEX-WC SECTIONS TO BE HUNG WITH PRE-STRESSED 12 GA.
HANGER WIRE TO SLAB OR STRUCTURAL STEEL ABOVE THE
CEILING ACCORDING TO ASTM C636, OR LOCAL BUILDING
CODES (AS APPLICABLE)
RECOMMENDED MAXIMUM DISTANCE BETWEEN HANGER
WIRE TO BE ~48"
ALL FULL TEES AND CROSS TEES FACTORY PUNCHED EVERY
~6"

TOTAL CEILING SYSTEM WEIGHT =	98 lbs
APEX-WC =	86 lbs
APEX-CP =	12 lbs

PROJECT:

274236	Revision: 0	03-22-2022
--------	-------------	------------

APEX-WC: WELDED CEILING SYSTEM

INTEGRATION DETAILS

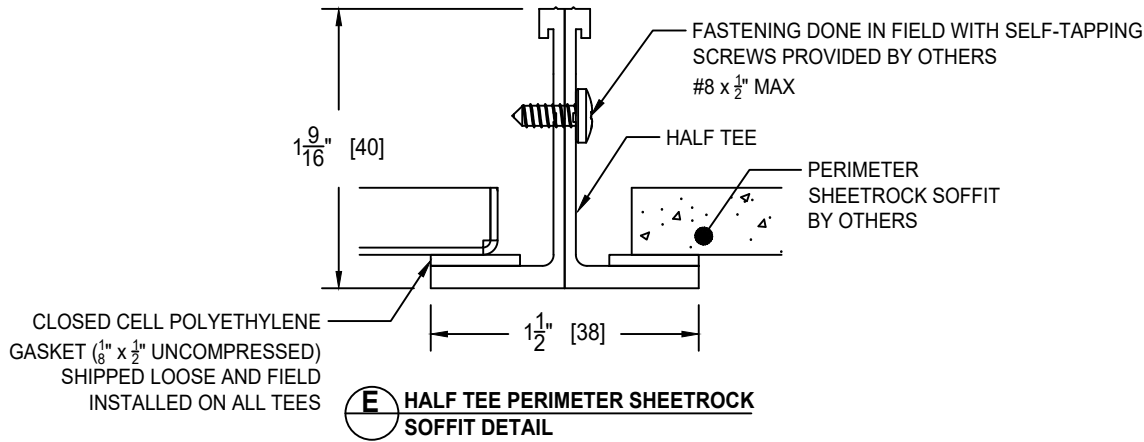
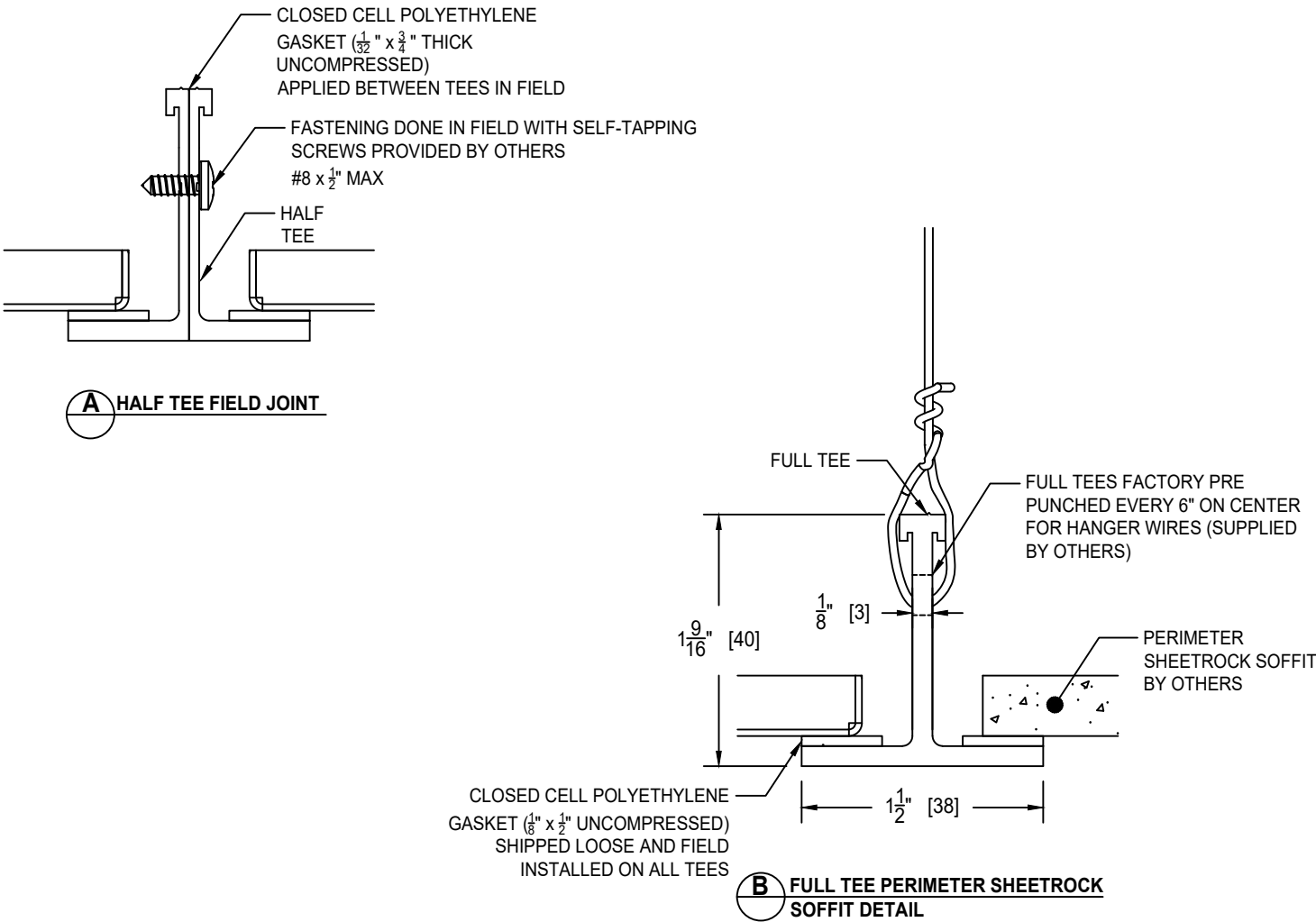

WELDED SECTION ISOMETRIC VIEW

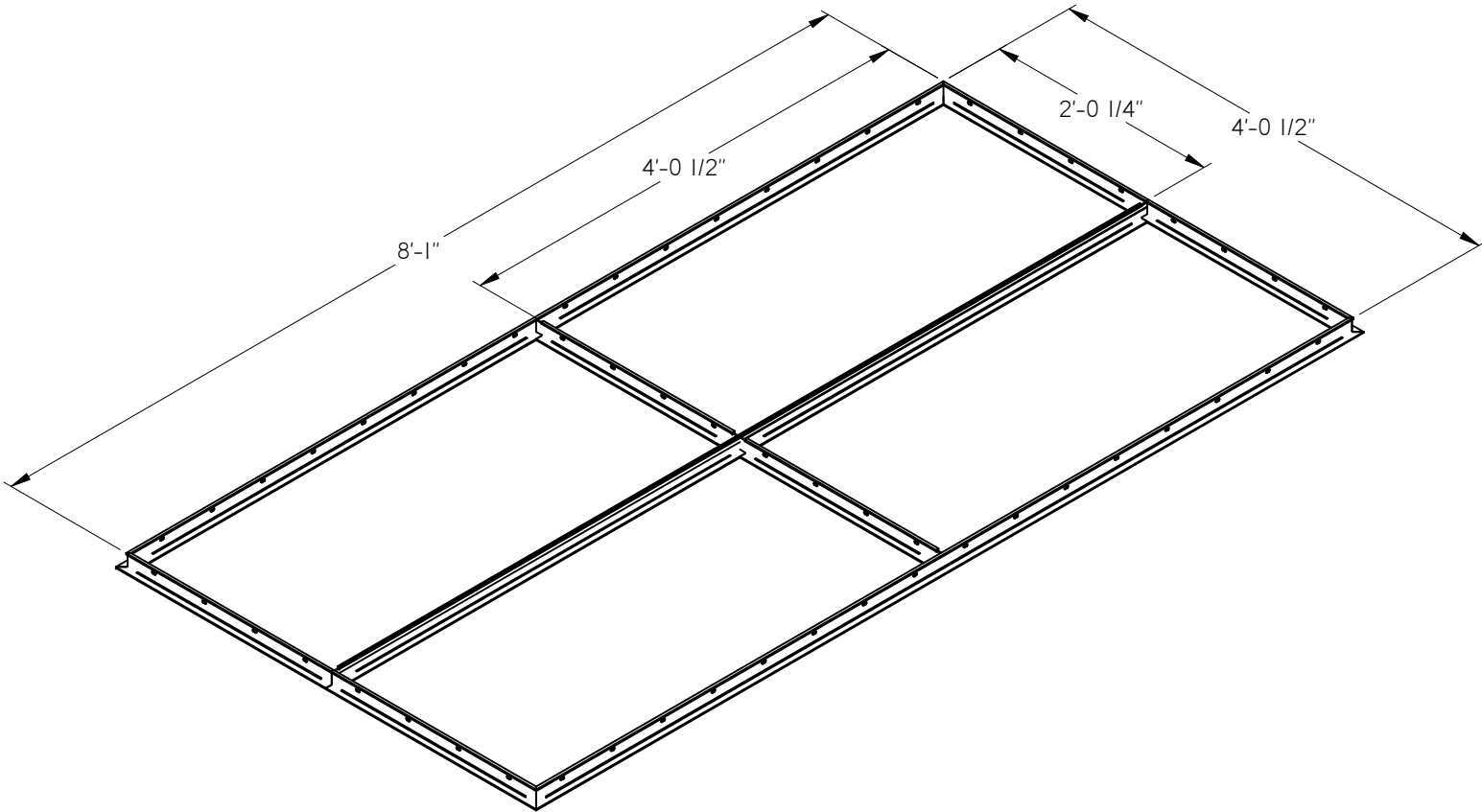

PROJECT:

274236

Revision: 0

03-22-2022

APEX-CP: CEILING PANELS

SC - SOLID CORE

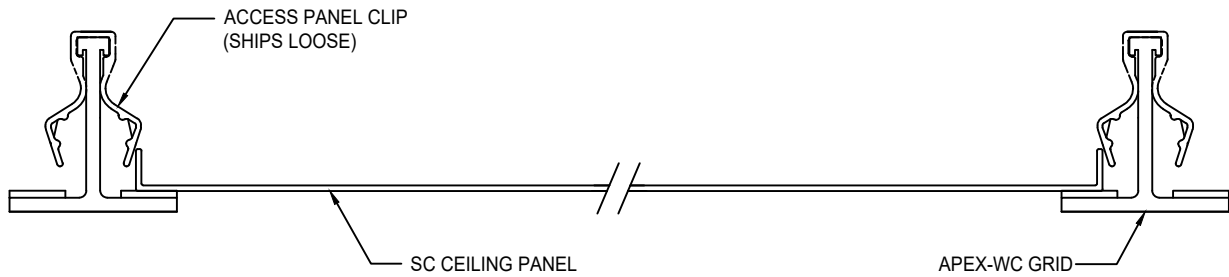
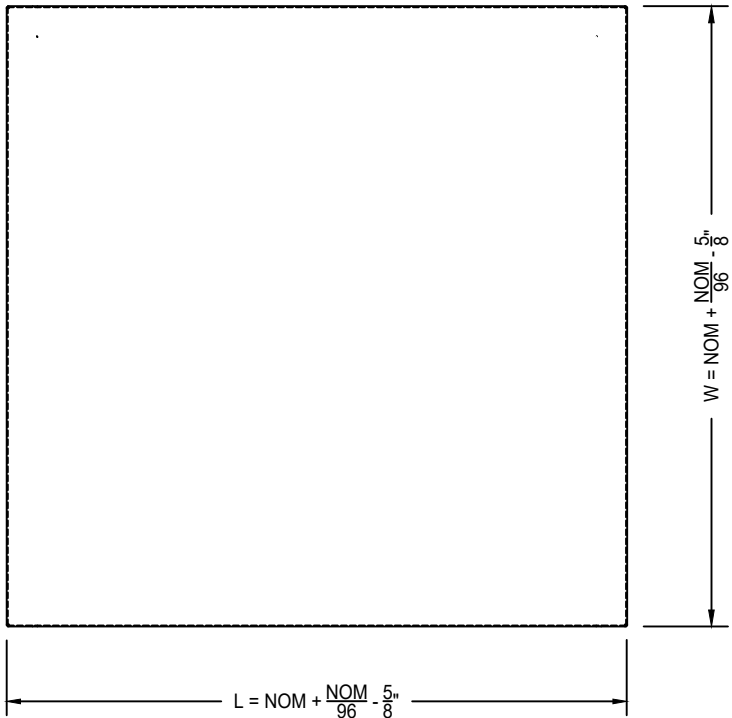

SCF - SOLID CORE WITH FLUSH MOUNT FRAME

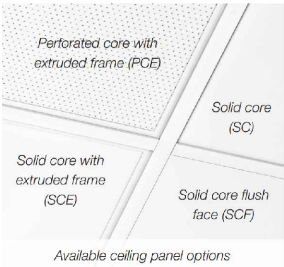
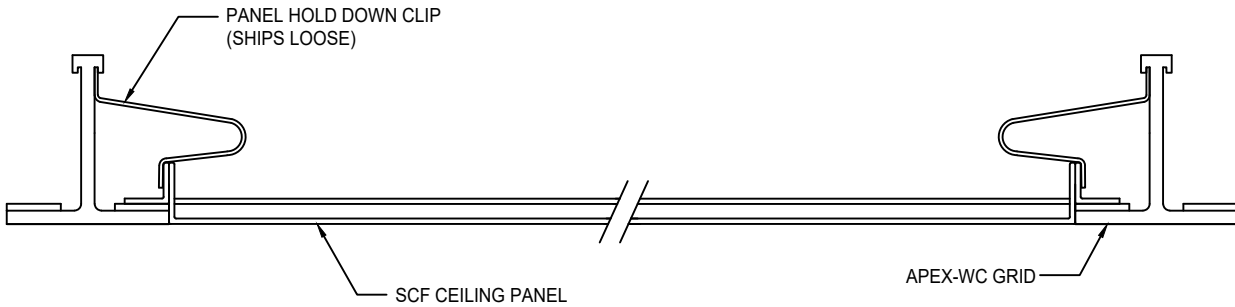
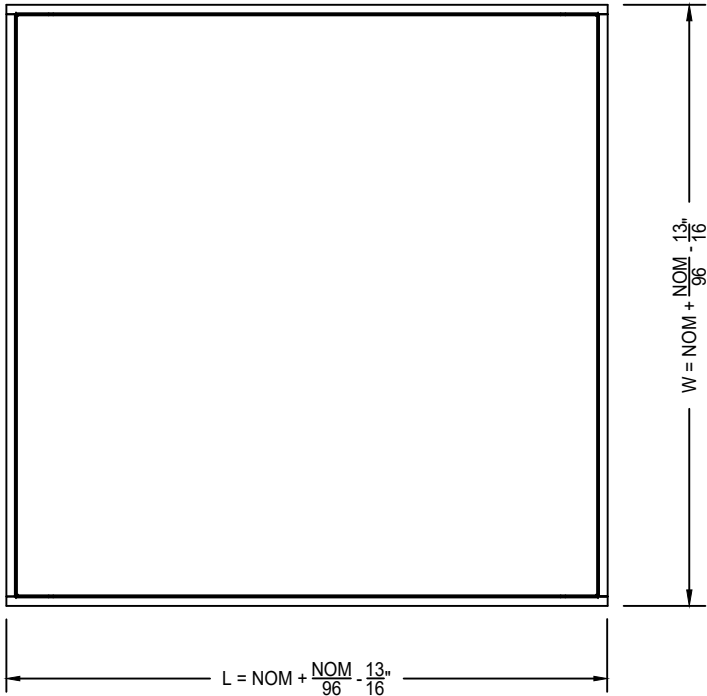

PANEL MATERIAL / FINISH:
- SC PANEL - .080" ALUMINUM / B12 STANDARD WHITE
- SCF PANEL - .040" ALUMINUM / B12 STANDARD WHITE

CEILING TYPE:
- APEX-WC - 1 1/2" CLEANROOM WELDED CEILING SYSTEM

PROJECT:

274236	Revision: 0	03-22-2022
--------	-------------	------------

APEX

APEX-MF: MOUNTING FRAME

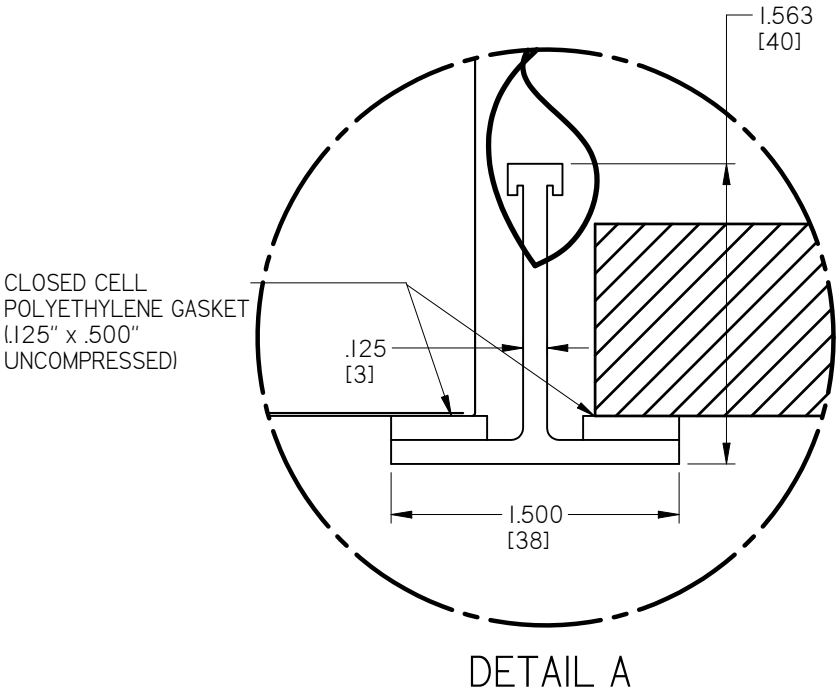
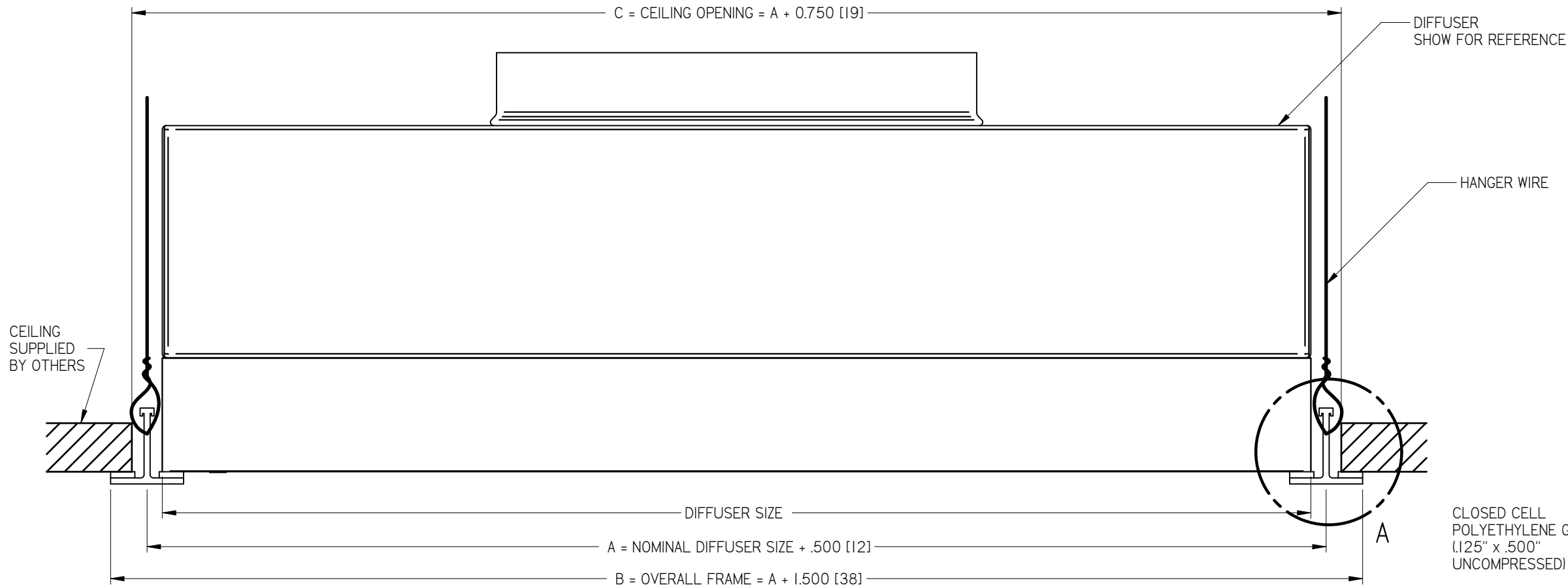

STANDARD CONSTRUCTION

- HEAVY DUTY, EXTRUDED HEAVY ALUMINUM TEES WITH POLYETHYLENE GASKET (FACTORY APPLIED)
- TEES FACTORY PRE PUNCHED EVERY 6" ON CENTER FOR HANGER WIRES (SUPPLIED BY OTHERS)
- FACTORY WELDED CORNERS; SHIPS IN SINGLE FACTORY WELDED FRAME ASSEMBLY

FINISH OPTIONS

- ☐ B12 STANDARD WHITE
- ☐ B11 BRIGHT WHITE
- ☐ B18 SILVER
- ☐ B25 CUSTOM MATCHED COLOR
- ☐ AC ANODIZED CLEAR

PROJECT:

274236	Revision: 0	03-22-2022
--------	-------------	------------