

# SUPERSUITE

## OPERATING ROOM DIFFUSER SYSTEM WITH INTEGRATED LED LIGHTING EXAMPLE SYSTEM FOR A TRADITIONAL OR

FEATURES:

- LAMINAR FLOW DIFFUSER ARRAY WITH INTEGRATED HIGH-PERFORMANCE LED LIGHTS INSIDE EACH INDIVIDUAL MODULE
- FULLY CUSTOMIZABLE TO MATCH THE DEMANDING AND OFTEN CROWDED MODERN HOSPITAL AND CLEANROOM CEILING LAYOUTS
- OPTIONAL PERIMETER APEX WELDED CEILING GRID SUPPORTS ACCESS PANELS AND FLUSH-MOUNT PANELS FOR EQUIPMENT BOOM INTEGRATION
- UL 1598 CERTIFIED, AIR-HANDLING LUMINAIRE

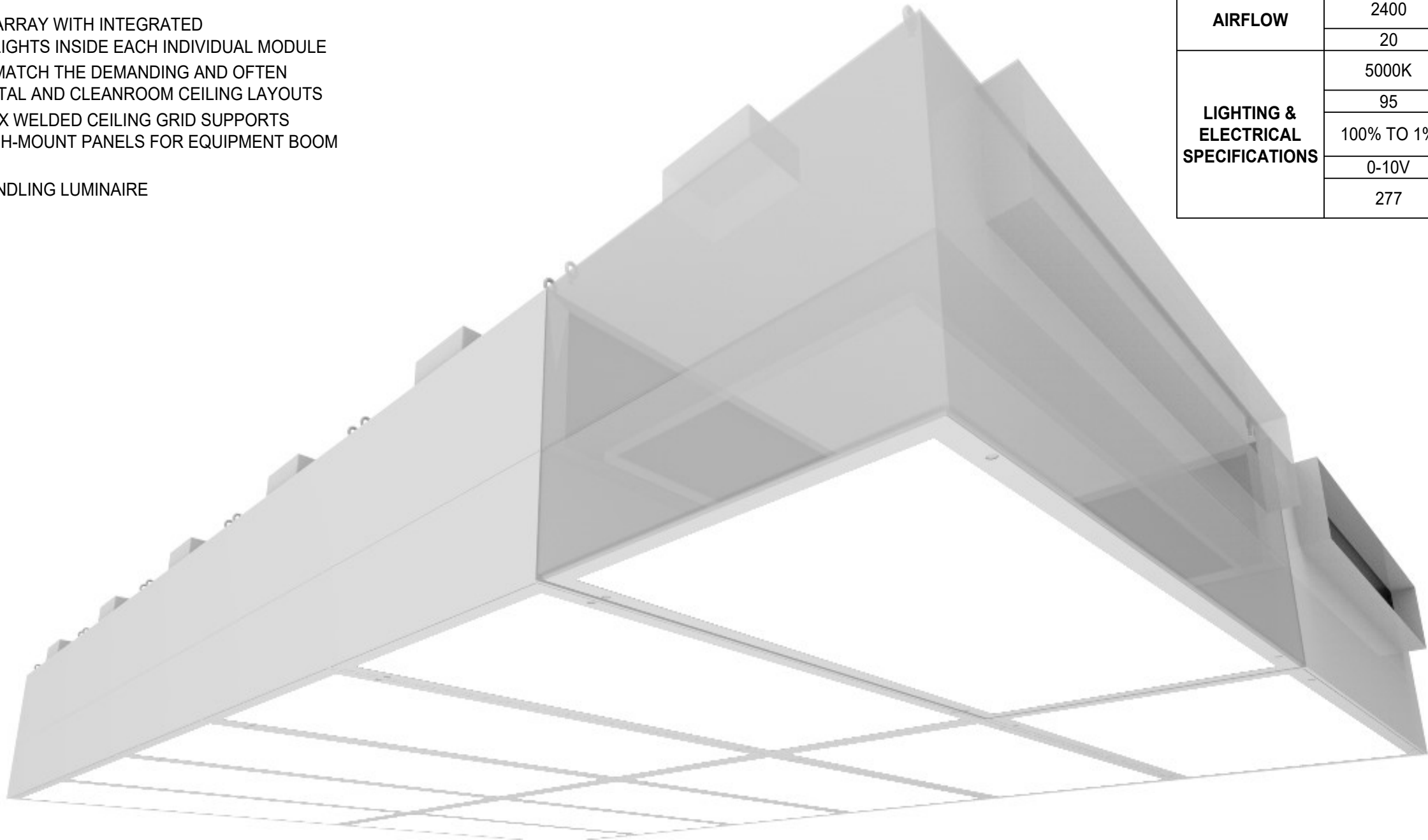

EXAMPLE SYSTEM		
AIRFLOW	2400	CFM
	20	ACH
LIGHTING & ELECTRICAL SPECIFICATIONS	5000K	COLOUR TEMPERATURE
	95	CRI
	100% TO 1%	DIMMING
	0-10V	
	277	INCOMING VOLTAGE



<div>SUPERSUITE</div> <div>by price</div>		
Project:		
274977	Revision: B	08-01-2023

OPERATING ROOM DIFFUSER SYSTEM WITH INTEGRATED LED LIGHTING  
3D INTERACTIVE MODEL - TRADITIONAL OR

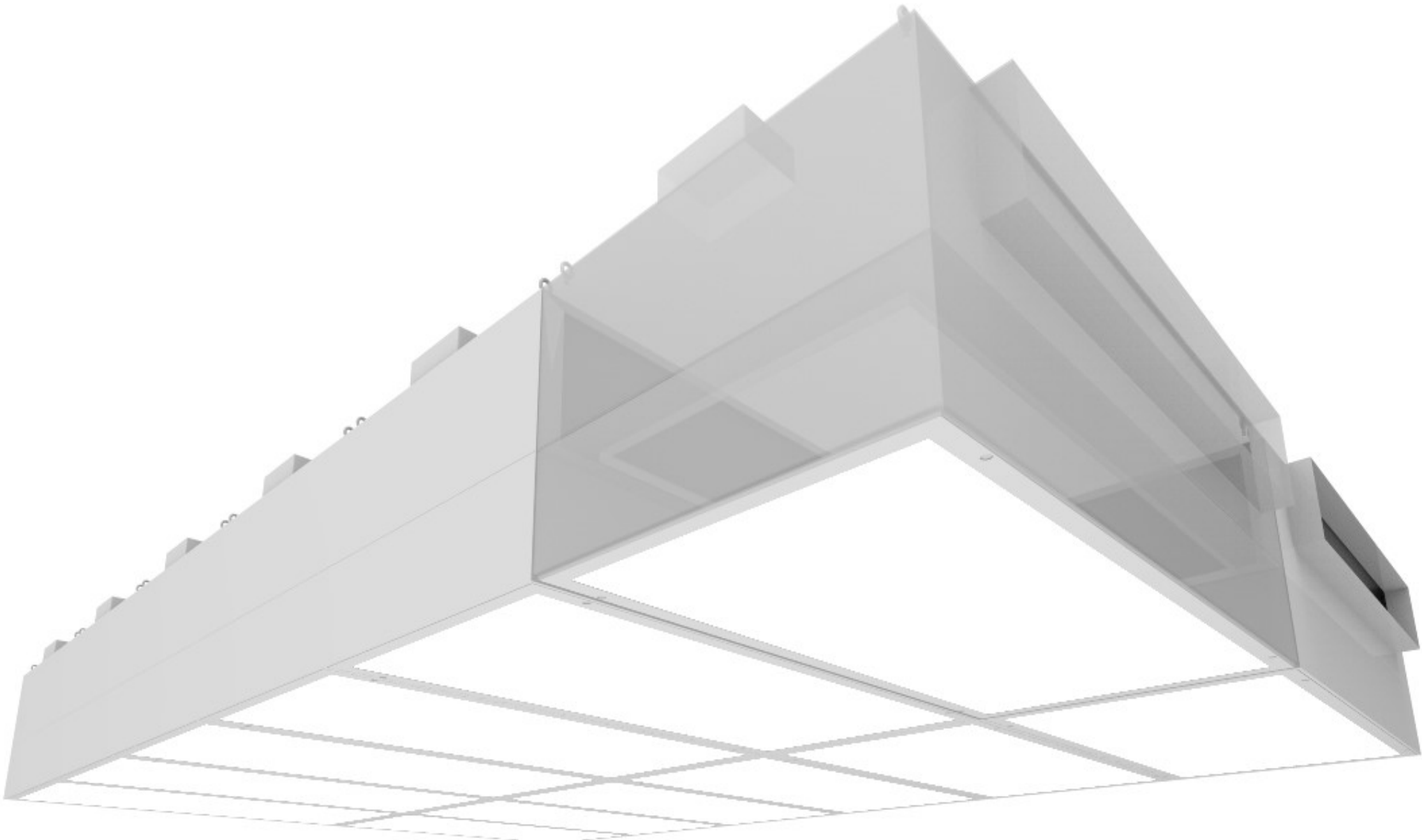

ORDER OF INSTALLATION  
(CLICK BUTTONS TO TOGGLE VIEWS)

- BOOM SUPPORTS  
(by Others)
- SUPERSUITE  
(View A)
- SUPERSUITE  
(View B)
- SUPERSUITE  
(View C)
- APEX CEILING GRID  
(View A)
- APEX CEILING GRID  
(View B)
- APEX-CP-SC CEILING PANELS
- APEX-CP-SCF CEILING PANELS
- FINAL INSTALLATION

- USE THE SCROLL WHEEL TO ZOOM
- HOLD DOWN THE LEFT MOUSE BUTTON TO ROTATE
- HOLD DOWN CTRL AND LEFT MOUSE BUTTON TO MOVE

CLICK IMAGE TO  
ACTIVATE 3D PDF



Project:		
274977	Revision: B	08-01-2023

# SUPERSUITE

## OPERATING ROOM DIFFUSER SYSTEM WITH INTEGRATED LED LIGHTING

### REFLECTED CEILING PLAN - TRADITIONAL OR

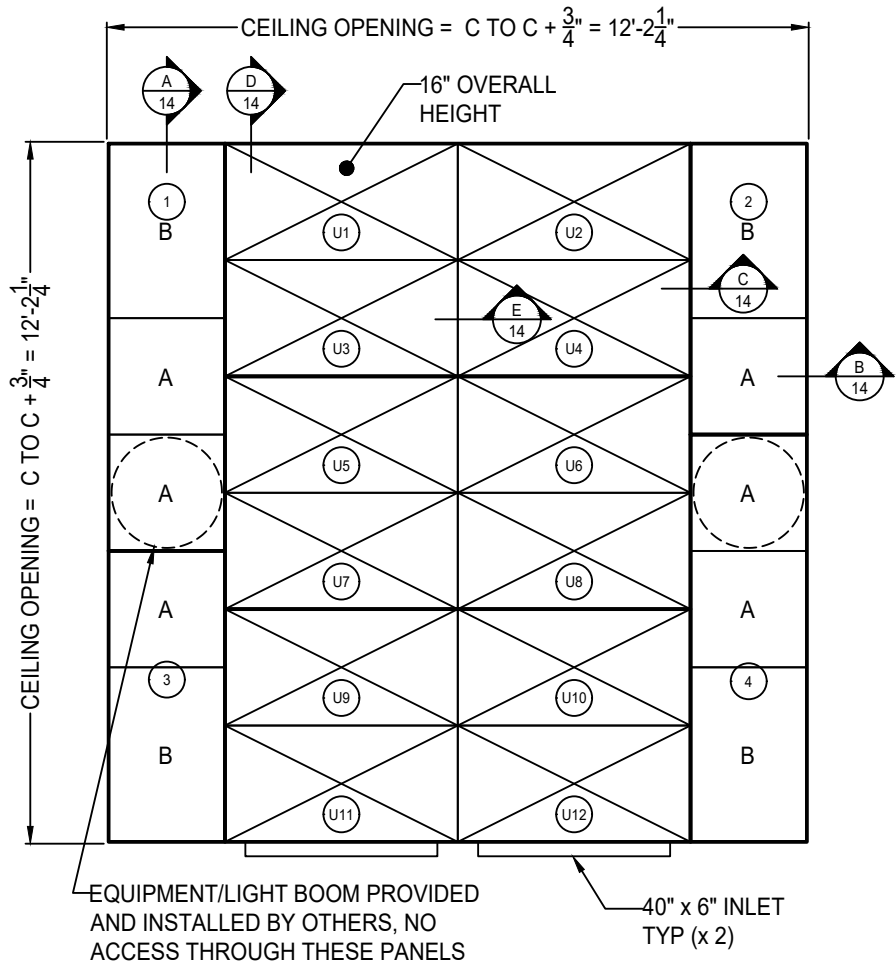

SSA AREA = 96 sq. ft.      APEX AREA = 51 sq. ft.

SSA - SUPERSUITE MODULES	APEX LOOSE HALF TEE PERIMETER TRIM PIECE	SCF - SOLID CORE FLUSH MOUNT PANELS	SC - SOLID CORE ACCESS PANELS
24 x 48 (x 12)	120" (x 2)	A: 24 x 24 (x 2)	A: 24 x 24 (x 4) B: 24 x 36 (x 4)

- B12 STANDARD WHITE FINISH
- PANEL CUTOUTS FOR BOOMS DONE IN FIELD BY OTHERS
- THE CEILING IS FACTORY PREMANUFACTURED TO SIZES AND TOLERANCE +/- 1/16"
- SITE ADJUSTMENTS TO PERIMETER SOFFITS AND/OR DRYWALL MAY BE REQUIRED AND ARE THE RESPONSIBILITY OF THE INSTALLER
- ASHRAE 170 VERIFICATION IS SHOWN TO ASSIST IN PROJECT COORDINATION. FINAL ASHRAE 170 COMPLIANCE, AS WELL AS COMPLIANCE WITH ALL APPLICABLE LOCAL CODES AND REQUIREMENTS REMAINS THE RESPONSIBILITY OF THE EOR OR INSTALLER ON THE PROJECT

### ASHRAE 170-2021 TABLE COVERAGE VERIFICATION - TRADITIONAL OR

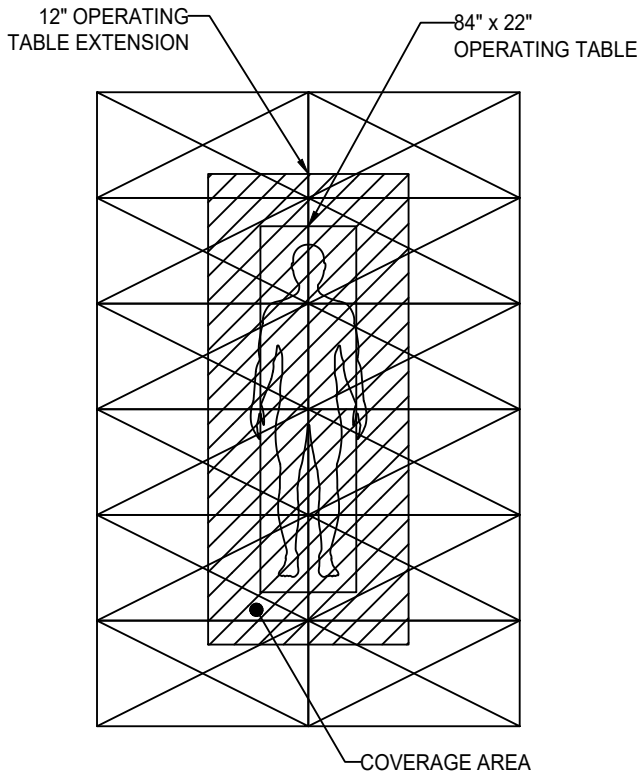

THIS LAYOUT COMPLIES WITH ASHRAE 170-2021 7.4.1.b.

ASHRAE 170-2021 7.4.1.a. COMPLIANCE AIRFLOW RANGE	ASHRAE 170-2021 7.4.1.b. COMPLIANCE
2400 - 3360 CFM BASED ON 96 SQFT	0% OF THE 12" OPERATING TABLE EXTENSION USED FOR NON DIFFUSER USES

### ASHRAE 170-2021

- 7.4.1.a. - THE AIRFLOW SHALL BE UNIDIRECTIONAL, DOWNWARDS, AND THE **AVERAGE VELOCITY OF THE DIFFUSERS SHALL BE 25 TO 35 CFM/SQFT** (127 TO 178 L/S/SQM). THE DIFFUSERS SHALL BE CONCENTRATED TO PROVIDE AN AIRFLOW PATTERN OVER THE PATIENT AND SURGICAL TEAM.
- 7.4.1.b. - THE COVERAGE AREA OF THE PRIMARY SUPPLY DIFFUSER ARRAY SHALL EXTEND A MINIMUM OF 12 IN. (305 mm) BEYOND THE FOOTPRINT OF THE SURGICAL TABLE ON EACH SIDE. WITHIN THE PORTION OF THE PRIMARY SUPPLY DIFFUSER ARRAY THAT CONSISTS **OF AN AREA ENCOMPASSING 12 IN. (305mm) ON EACH SIDE OF THE FOOTPRINT OF THE SURGICAL TABLE, NO MORE THAN 30% OF THIS PORTION OF THE PRIMARY SUPPLY DIFFUSER ARRAY AREA SHALL BE USED FOR NON DIFFUSER USES** SUCH AS LIGHTS, GAS COLUMNS, EQUIPMENT BOOMS, ACCESS PANELS, SPRINKLERS, ETC.

**SUPERSUITE**  
by **PRICE**

Project:

274977

Revision: B

08-01-2023

## OPERATING ROOM DIFFUSER SYSTEM WITH INTEGRATED LED LIGHTING PHOTOMETRIC ANALYSIS - TRADITIONAL OR

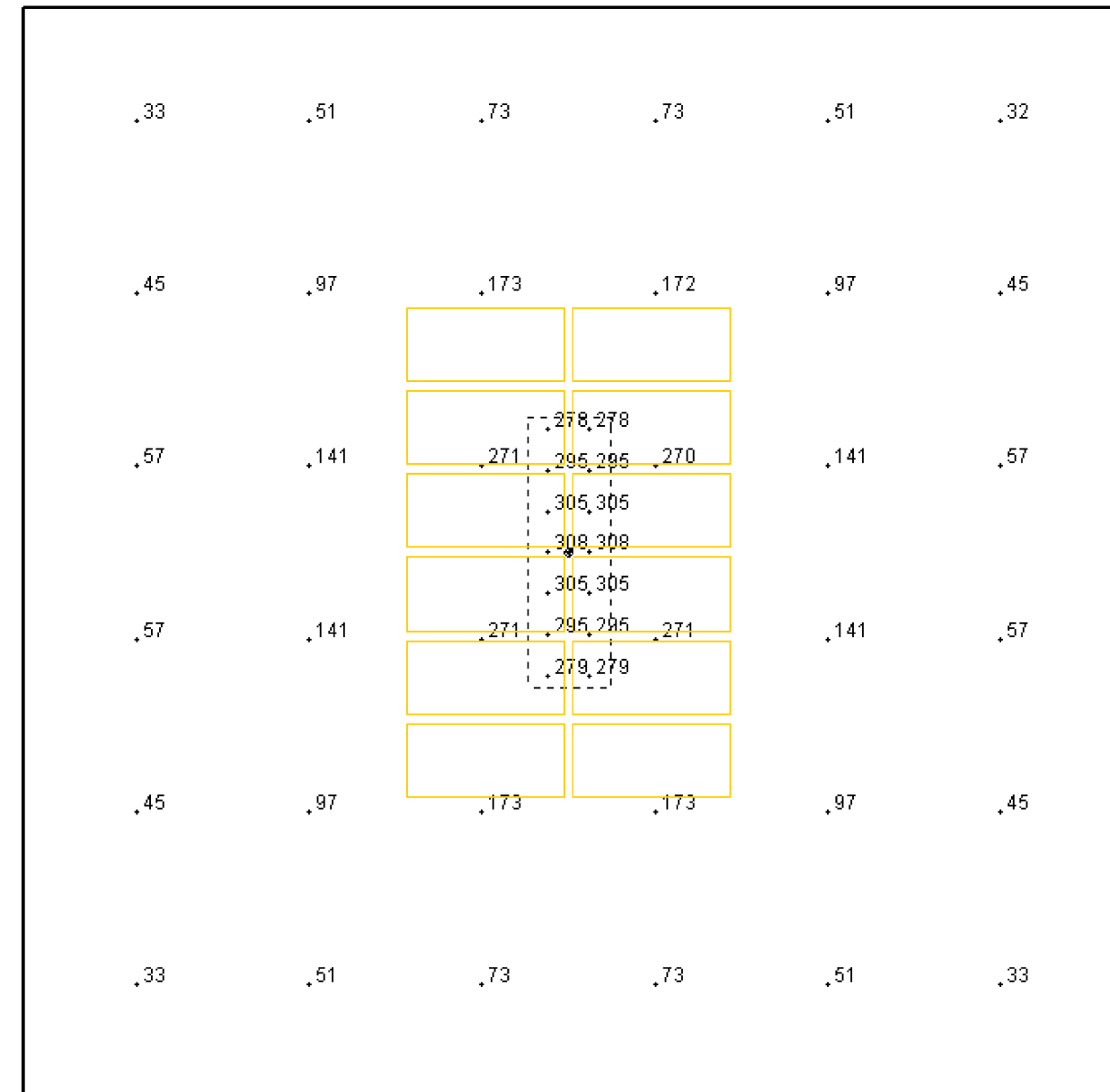
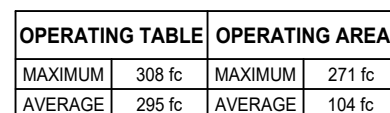

**SUPERSUITE**  
by price

08-01-2023

- PHOTOMETRIC ANALYSIS BASED ON A 3' CALCULATION ZONE, 720 ROOM SQFT & 10' CEILING HEIGHT.
- ANSI/IES RP-29-16 RECOMMENDS 3000 LUX (279 FC) AT THE OPERATING TABLE
- THE CALCULATED VALUES REFLECT ADDITIONAL SPACE LIGHTING BY OTHERS.
- LIGHTING ANALYSIS HAS BEEN PERFORMED USING THIRD PARTY LAB TESTED .IES FILES.
- THIS LAYOUT REFLECTS TWO ROWS OF 5000K, 90+ CRI LEDS PER MODULE. A THIRD ROW, HIGH OUTPUT OPTION IS AVAILABLE.
- LIGHTING CALCULATIONS ARE ESTIMATED USING BEST PRACTICE AND MAY DIFFER SLIGHTLY FROM ACTUAL FIELD CONDITIONS.

# SUPERSUITE

## OPERATING ROOM DIFFUSER SYSTEM WITH INTEGRATED LED LIGHTING

○ SRDC SUPER REMOTE DRIVER CABINETS - SINGLE DIMMING ZONE (100 TO 1% DIMMING) - TRADITIONAL OR

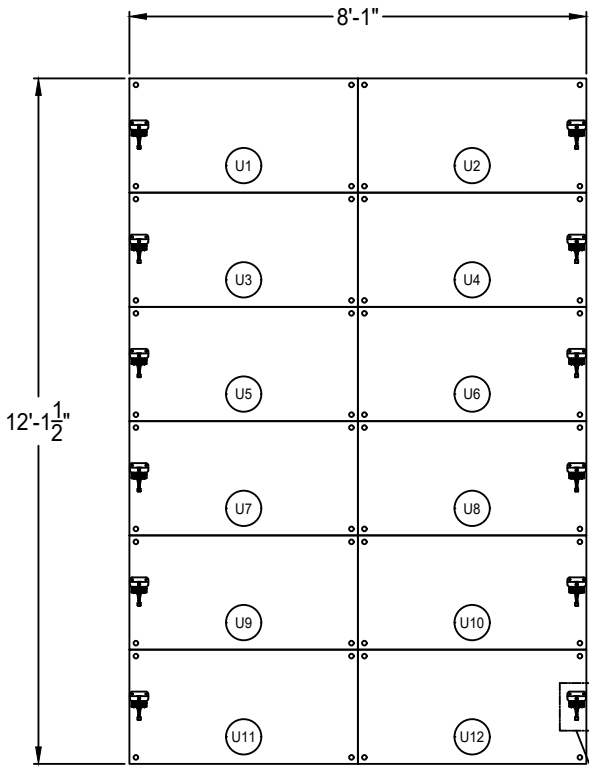
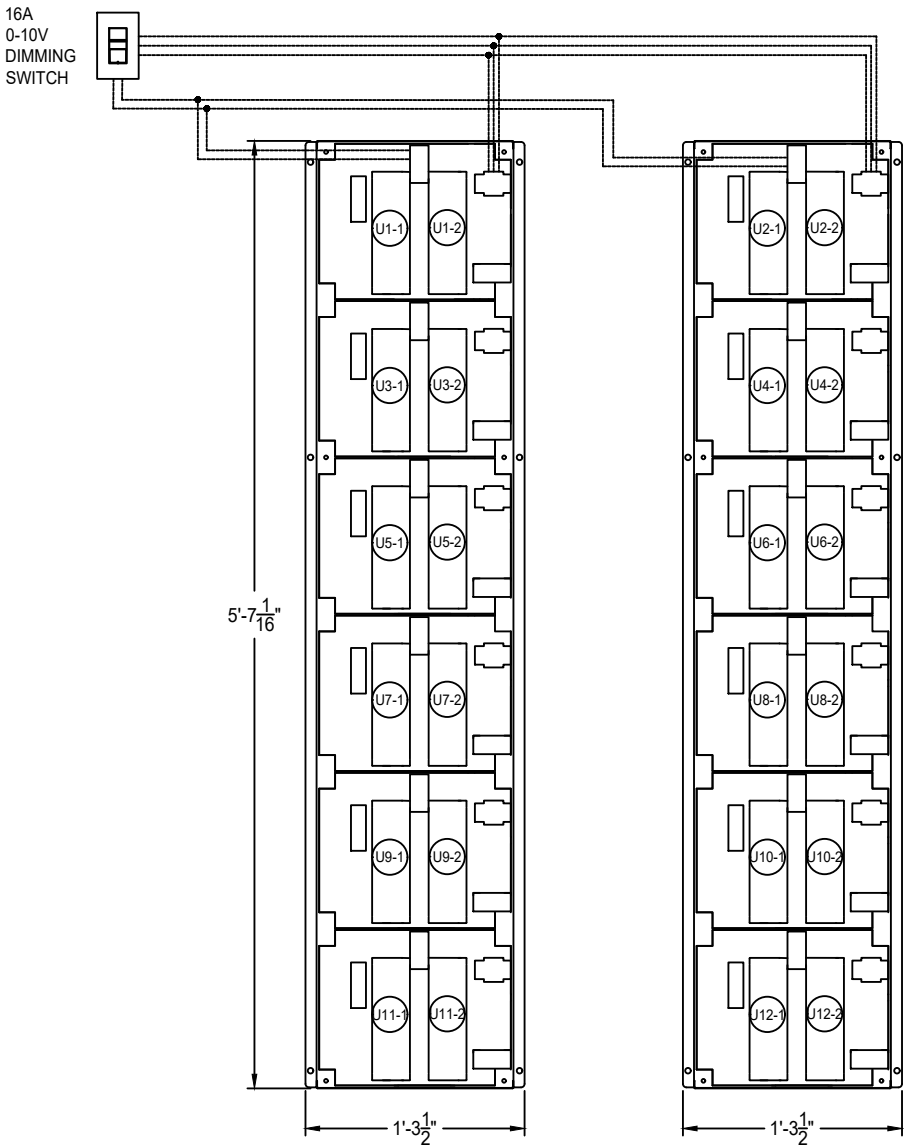

CABINET 1 - 1 OF 2 - CONTROLS 6 MODULES WITH 12 DRIVERS			
DRIVER TAG	LED WATTAGE	DRIVER TAG	LED WATTAGE
U1-1	88	U1-2	88
U3-1	88	U3-2	88
U5-1	88	U5-2	88
U7-1	88	U7-2	88
U9-1	88	U9-2	88
U11-1	88	U11-2	88
TOTAL WATTAGE:		AC CURRENT:	
1056		4.8A/277VAC	

CABINET 2 - 2 OF 2 - CONTROLS 6 MODULES WITH 12 DRIVERS			
DRIVER TAG	LED WATTAGE	DRIVER TAG	LED WATTAGE
U2-1	88	U2-2	88
U4-1	88	U4-2	88
U6-1	88	U6-2	88
U8-1	88	U8-2	88
U10-1	88	U10-2	88
U12-1	88	U12-2	88
TOTAL WATTAGE:		AC CURRENT:	
1056		4.8A/277VAC	



EACH STANDARD MODULE COMES WITH TWO ROWS OF LEDS THAT EACH REQUIRE ONE (+ & -) LOW VOLTAGE FIELD CONNECTION AND ARE NOTED BY A "UX-X" LABEL. A THIRD ROW, HIGH OUTPUT OPTION IS AVAILABLE IF REQUIRED.

EACH STANDARD MODULE COMES WITH 2 ROWS OF LED LIGHTS AND EACH ROW OF LIGHTS IS NOTED BY A "UX-X" LABEL. THE "UX" CORRESPONDS TO AN INDIVIDUAL MODULE REFERENCED IN THE RCP AND THE "-1" AND "-2" CORRESPONDS TO THE ROW OF LEDS FOR THAT MODULE. EACH "UX-X" LABEL CORRESPONDS TO ONE (+ & -) LOW VOLTAGE WIRE TO BE FIELD CONNECTED TO SRDC DRIVER CABINET AS PER THE MATCHING LABELS. EACH 100W DRIVER CAN POWER 1 ROW OF LEDS (ONE HALF OF A MODULE) AND EACH 600W DRIVER CAN CONTROL 6 ROWS OF LEDS (3 MODULES)

EACH MODULE COMES WITH A TOP MOUNTED TERMINAL BLOCK ENCLOSURE (COVER NOT SHOWN) FOR LOW VOLTAGE FIELD CONNECTIONS. QUICK CONNECT FITTING IS SEALED THROUGH PLENUM AND ALL INTERNAL WIRING IS COMPLETED IN THE FACTORY. EACH ROW OF LEDS REQUIRES ONE (+&-) LOW VOLTAGE FIELD CONNECTIONS (TWO PER MODULE)

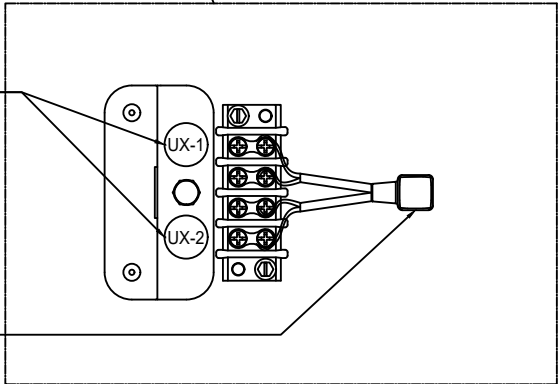

**SUPERSUITE**  
by **PRICE**

Project:

274977

Revision: B

08-01-2023

• INSTALLATION WORK AND ELECTRICAL WIRING MUST BE COMPLETED BY A CERTIFIED ELECTRICIAN AND/OR QUALIFIED PERSON(S) IN ACCORDANCE WITH APPLICABLE ELECTRICAL CODES AND STANDARDS

# SUPERSUITE

## OPERATING ROOM DIFFUSER SYSTEM WITH INTEGRATED LED LIGHTING SUPERSUITE SHIP SECTION BREAKDOWN & HANGING LOCATIONS - TRADITIONAL OR

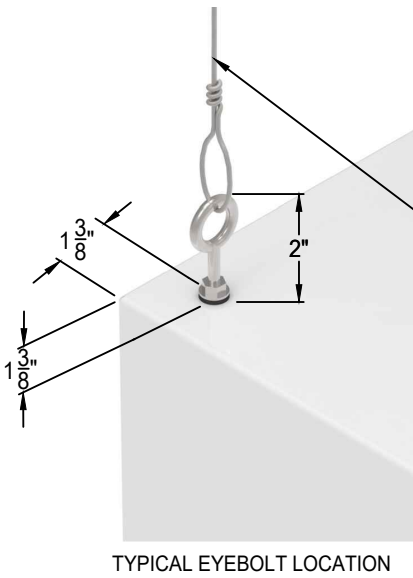
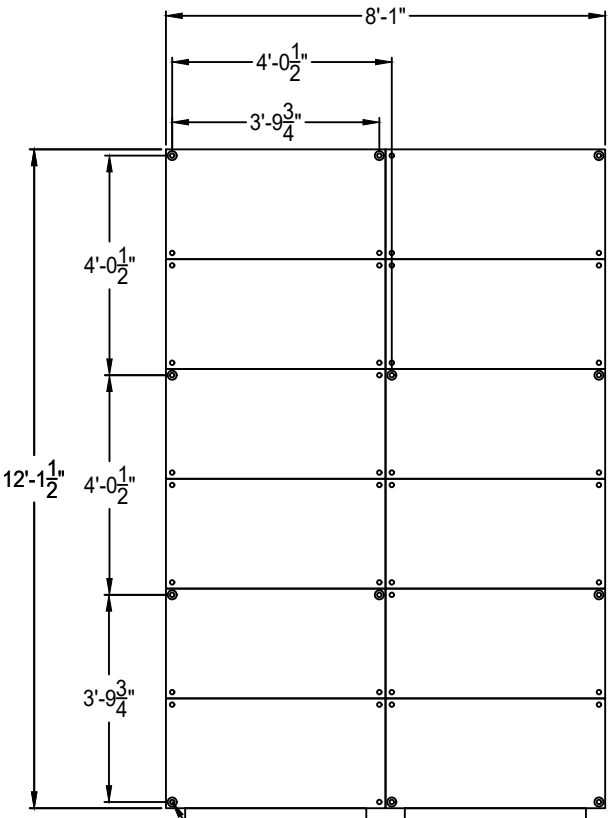
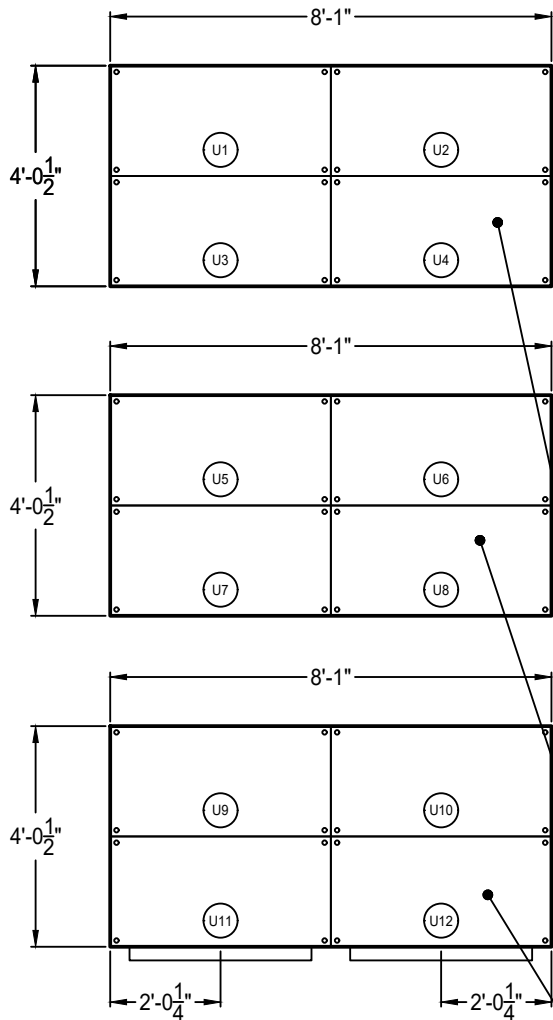

SSA SECTIONS TO BE HUNG WITH PRE-STRESSED 12 GA. HANGER WIRE TO SLAB OR STRUCTURAL STEEL ABOVE THE CEILING ACCORDING TO ASTM C636, OR LOCAL BUILDING CODES (AS APPLICABLE)

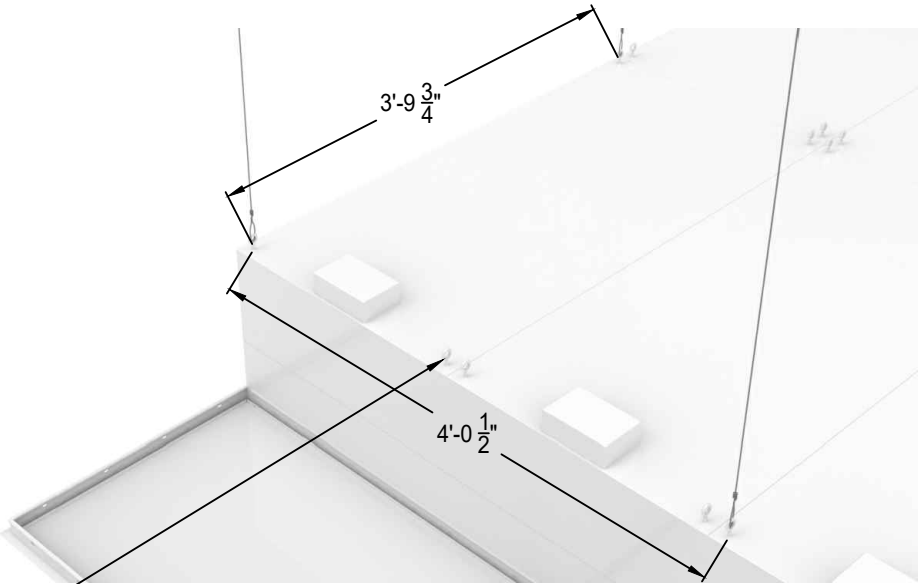

EACH SUPERSUITE MODULE COMES WITH 4 EYE BOLTS FOR HANGING. KEYSTONE RECOMMENDS HANGING SYSTEM EVERY ~4' AS REQUIRED

TYPICAL HANGER WIRE SPACING

SUPERSUITE SYSTEM SHIPS IN 3 SECTIONS TO BE FASTENED TOGETHER IN THE FIELD BY OTHERS WITH HARDWARE PROVIDED BY KEYSTONE

- SUPERSUITE SHIPS IN FACTORY WELDED SHIP SECTIONS TO BE FASTENED TOGETHER IN THE FIELD BY OTHERS
- MOUNTING LOCATIONS ARE SHOWN FOR REFERENCE ONLY. EXACT MOUNTING LOCATIONS TO BE DETERMINED BY THE EOR OR INSTALLER ON THE PROJECT AND MUST COMPLY WITH ALL APPLICABLE CODES AND STANDARDS.

**SUPERSUITE**  
by **PRICE**

Project:

274977

Revision: B

08-01-2023



# SUPERSUITE

## OPERATING ROOM DIFFUSER SYSTEM WITH INTEGRATED LED LIGHTING APEX SHIP SECTION BREAKDOWN & HANGING DETAILS - TRADITIONAL OR

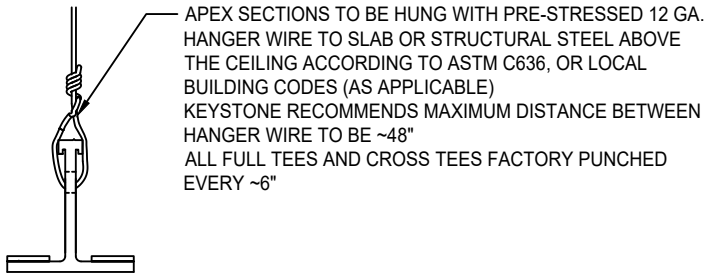
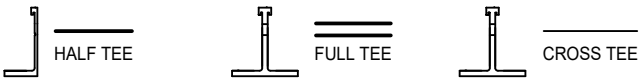
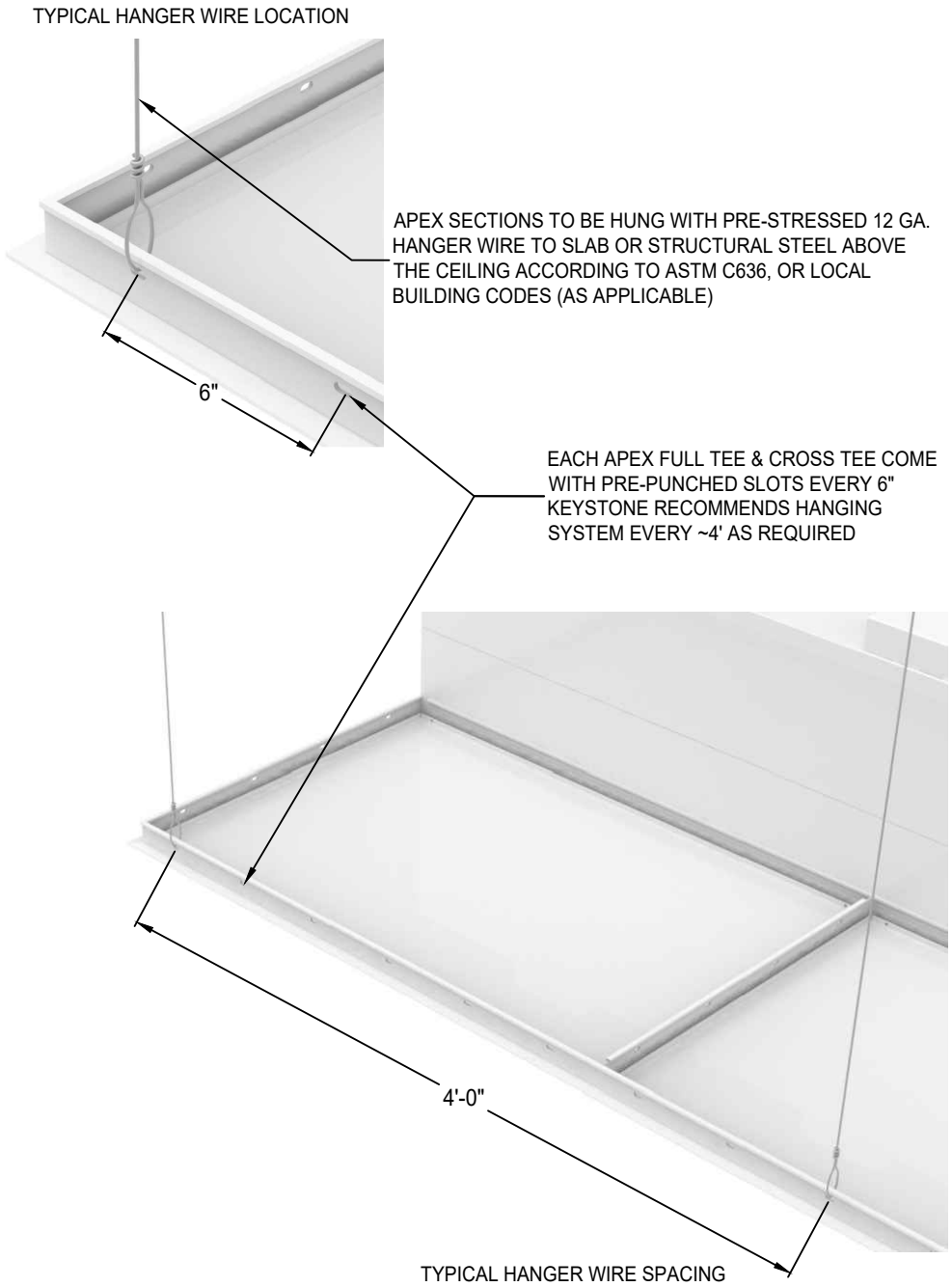
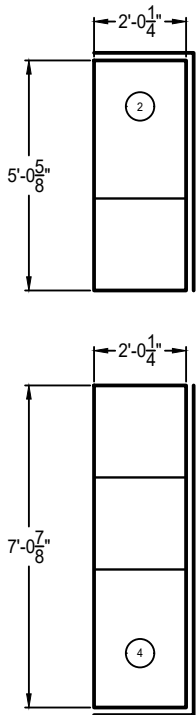
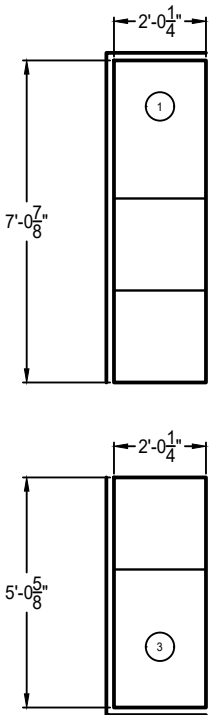
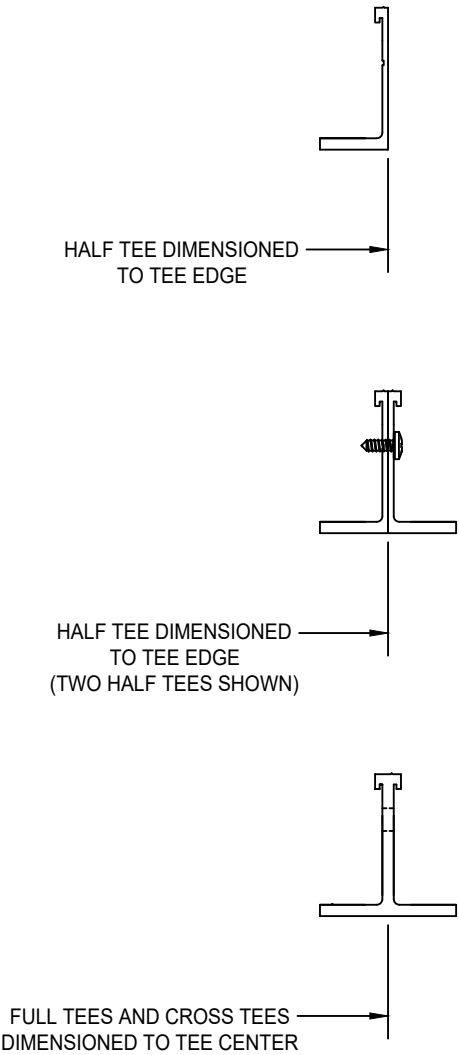

**SUPERSUITE**  
by **PRICE**

Project:		
274977	Revision: B	08-01-2023

- THE APEX GRID IS SUPPLIED IN MULTIPLE FACTORY ASSEMBLED SECTIONS NO LARGER THAN 10'x4'
- THE CEILING IS FACTORY PRE-MANUFACTURED TO SIZES AND TOLERANCE +/- <sup>1</sup>/<sub>16</sub>"

# SUPERSUITE

## OPERATING ROOM DIFFUSER SYSTEM WITH INTEGRATED LED LIGHTING

○ OPTIONAL OSHPD SEISMIC CERTIFICATION PRE-APPROVAL (OSP-0627-10)

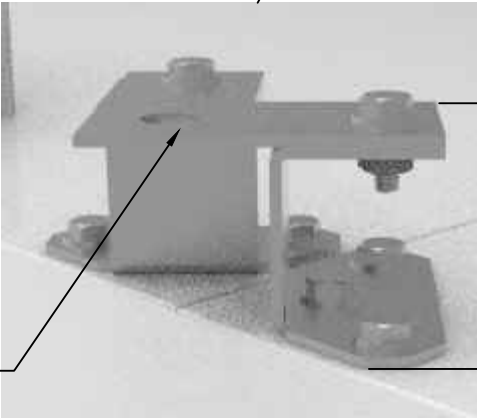
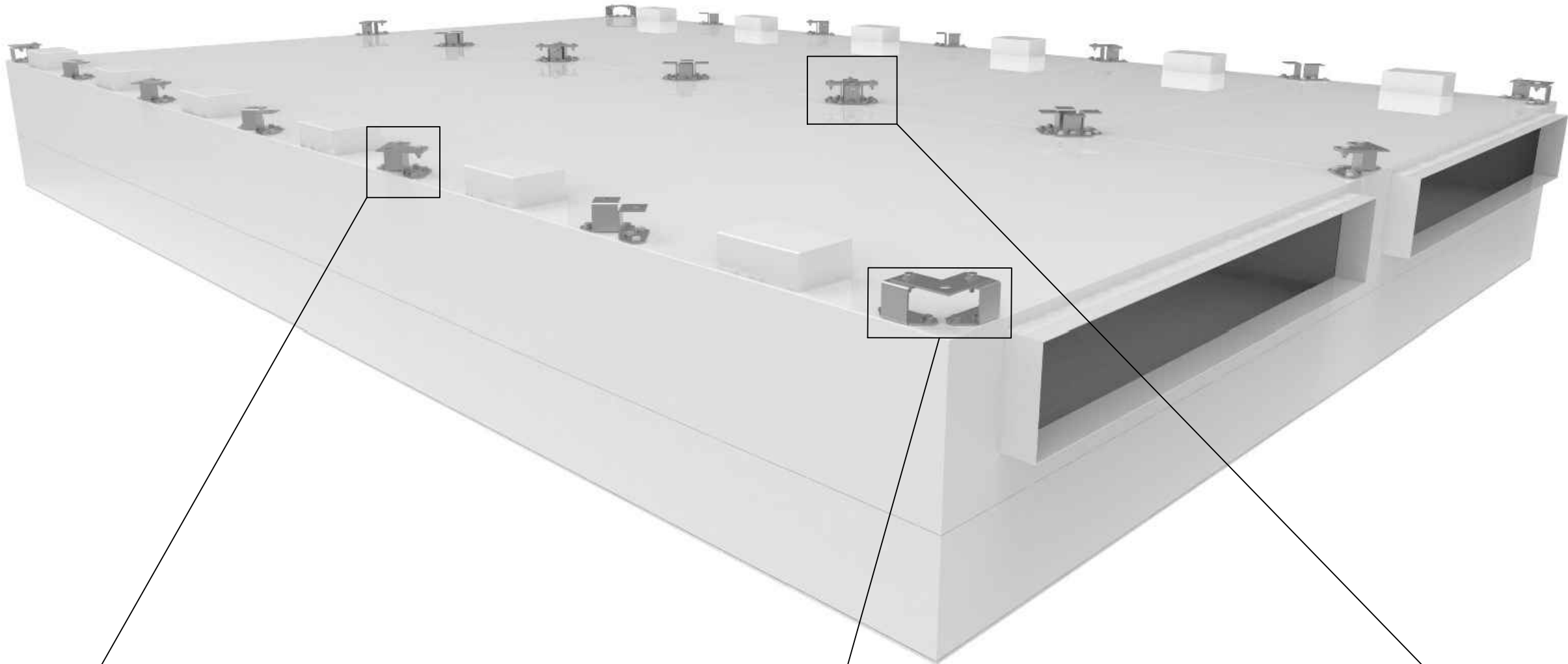

TWO MODULE  
CORNER BRACE  
DETAIL

1-3/4"  
(TYPICAL)

Ø9/16"  
(TYPICAL)

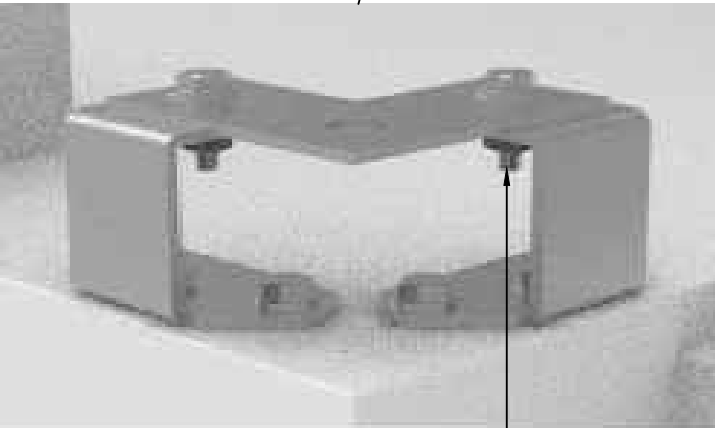

SINGLE MODULE  
CORNER BRACE  
DETAIL

1/4-20 MOUNTING HARDWARE  
PROVIDED BY OTHERS (TYPICAL)

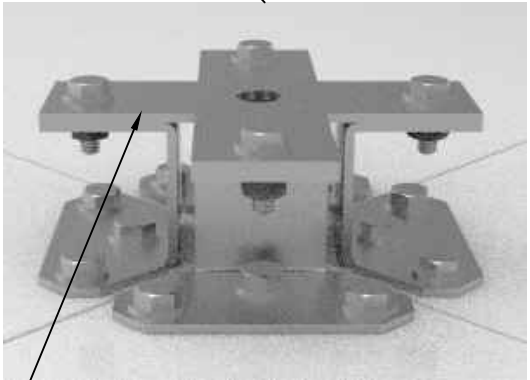

FOUR MODULE  
CENTER BRACE  
DETAIL

SEISMIC BRACKET TOP PLATES  
SHIPPED LOOSE FOR FIELD  
INSTALLATION(TYPICAL)

- MOUNTING HARDWARE & SUPPORTS PROVIDED BY OTHERS.
- ALL HANGER AND SUPPORT BRACKETS ARE 12 GAUGE GALVANIZED STEEL. BRACKETS ARE SIZED TO ACCEPT 1/2" THREADED ROD PROVIDED BY OTHERS.
- OSHPD SPECIAL SEISMIC CERTIFICATION PRE-APPROVAL PER OSP-0627-10.
- ENGINEERED STRUCTURAL DRAWINGS BY OTHERS ARE REQUIRED IN ACCORDANCE WITH OSP-0627-10.
- MASON SCB2/SCBH2 CABLE BRACES REQUIRED PER OSP-0627-10.
- LATERAL BRACING REQUIRED PER OSP-0627-10.
- RECOMMENDED HANGING POINTS ARE SHOWN BASED ON CORNER AND CENTER BRACE LOCATIONS.
- EXACT MOUNTING LOCATIONS TO BE DETERMINED BY THE EOR OR INSTALLER ON THE PROJECT AND MUST COMPLY WITH ALL APPLICABLE CODES AND STANDARDS
- INSTALLATION WORK MUST BE DONE BY QUALIFIED PERSON(S) IN ACCORDANCE WITH ALL APPLICABLE CODES & STANDARDS.

**SUPERSUITE**  
by **price**

Project:

274977

Revision: B

08-01-2023



# SUPERSUITE

## OPERATING ROOM DIFFUSER SYSTEM WITH INTEGRATED LED LIGHTING

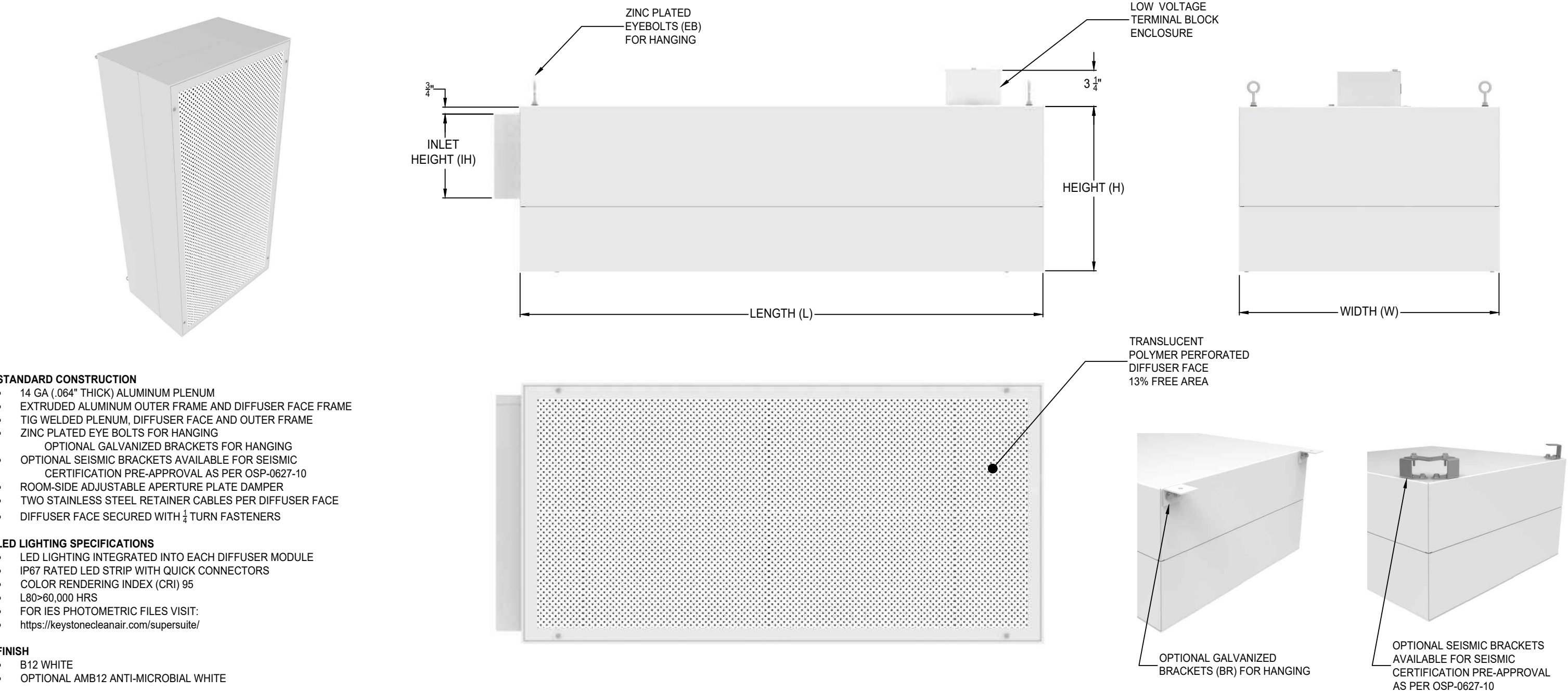

### STANDARD CONSTRUCTION

- 14 GA (.064" THICK) ALUMINUM PLENUM
- EXTRUDED ALUMINUM OUTER FRAME AND DIFFUSER FACE FRAME
- TIG WELDED PLENUM, DIFFUSER FACE AND OUTER FRAME
- ZINC PLATED EYE BOLTS FOR HANGING
  - OPTIONAL GALVANIZED BRACKETS FOR HANGING
- OPTIONAL SEISMIC BRACKETS AVAILABLE FOR SEISMIC CERTIFICATION PRE-APPROVAL AS PER OSP-0627-10
- ROOM-SIDE ADJUSTABLE APERTURE PLATE DAMPER
- TWO STAINLESS STEEL RETAINER CABLES PER DIFFUSER FACE
- DIFFUSER FACE SECURED WITH 1/4 TURN FASTENERS

### LED LIGHTING SPECIFICATIONS

- LED LIGHTING INTEGRATED INTO EACH DIFFUSER MODULE
- IP67 RATED LED STRIP WITH QUICK CONNECTORS
- COLOR RENDERING INDEX (CRI) 95
- L80>60,000 HRS
- FOR IES PHOTOMETRIC FILES VISIT:  
<https://keystonecleanair.com/supersuite/>

### FINISH

- B12 WHITE
- OPTIONAL AMB12 ANTI-MICROBIAL WHITE

### LED COLOR TEMPERATURE

- 5000K (W935)
- OPTIONAL 4000K (W930)

### LISTINGS

- **UL 1598/CSA C22.2 #250.0** - AIR-HANDLING LUMINAIRES
- **UL 2043** - FIRE TEST FOR HEAT AND VISIBLE SMOKE RELEASE FOR DISCRETE PRODUCTS AND THEIR ACCESSORIES INSTALLED IN AIR-HANDLING SPACES
- **UL 2108/CSA 22.2#250.0** - LOW VOLTAGE LIGHTING SYSTEM
- **UL 8750/CSA-C22.2 #250.13** - LIGHT EMITTING DIODE (LED) EQUIPMENT FOR USE IN LIGHTING PRODUCTS
- **UL 1310/CSA C22.2 #223-M91** - CLASS 2 POWER UNITS
- **UL 94** - FLAMMABILITY OF PLASTIC MATERIALS FOR PARTS IN DEVICES AND APPLIANCES
- **IP 67** - RATED INGRESS PROTECTION AGAINST DUST AND LIQUIDS
- **MIL-STD-461** - ELECTROMAGNETIC COMPATIBILITY
- **OSP-0627-10** - SEISMIC PRE-APPROVAL

STANDARD MODULE SIZING CHART					
NOMINAL (W)	NOMINAL (L)	ACTUAL (W)	ACTUAL (L)	HEIGHT (H)	
				MIN	MAX
24.000	24.000	24.250	24.250	10	20
24.000	36.000	24.250	36.375	10	20
24.000	48.000	24.250	48.500	10	20

- STANDARD HEIGHT (H) = 15"
- MINIMUM HEIGHT WITH HEPA FILTER = 12"
- MINIMUM WIDTH WITH HEPA FILTER =12"
- MAX INLET HEIGHT (IH) = HEIGHT (H) - 7"
- MAX INLET HEIGHT (IH) WITH HEPA = HEIGHT (H) - 8"

KEYSTONE CEILING SYSTEM WEIGHTS		
KEYSTONE SUPPLIED COMPONENTS	TOTAL SQUARE FEET =195 SQ.FT.	734 lbs.
SSA	96 SQ.FT.	672 lbs.
APEX	51 SQ.FT.	26 lbs.
PANELS	48 SQ.FT.	36 lbs.

<div>SUPERSUITE</div> <div>by price</div>		
Project:		
274977	Revision: B	08-01-2023

# SUPERSUITE

## OPERATING ROOM DIFFUSER SYSTEM WITH INTEGRATED LED LIGHTING

### FACE ACCESS APERTURE PLATE DAMPER DETAILS

- OPTIONAL ROOMSIDE HEPA FILTRATION

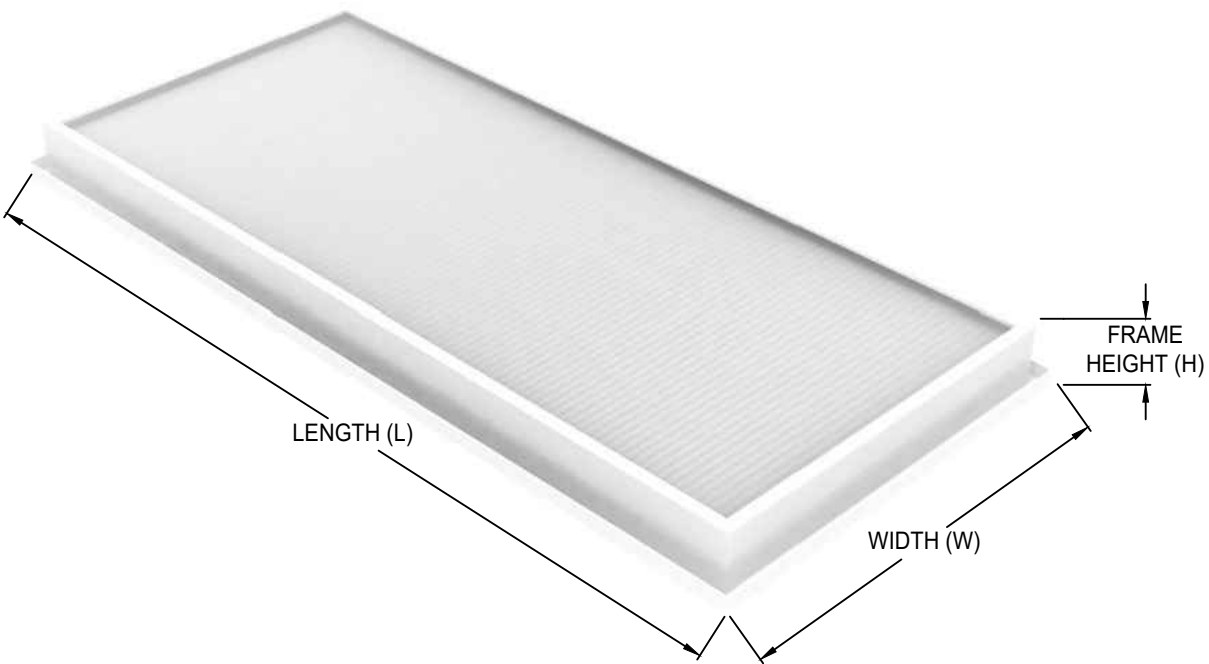
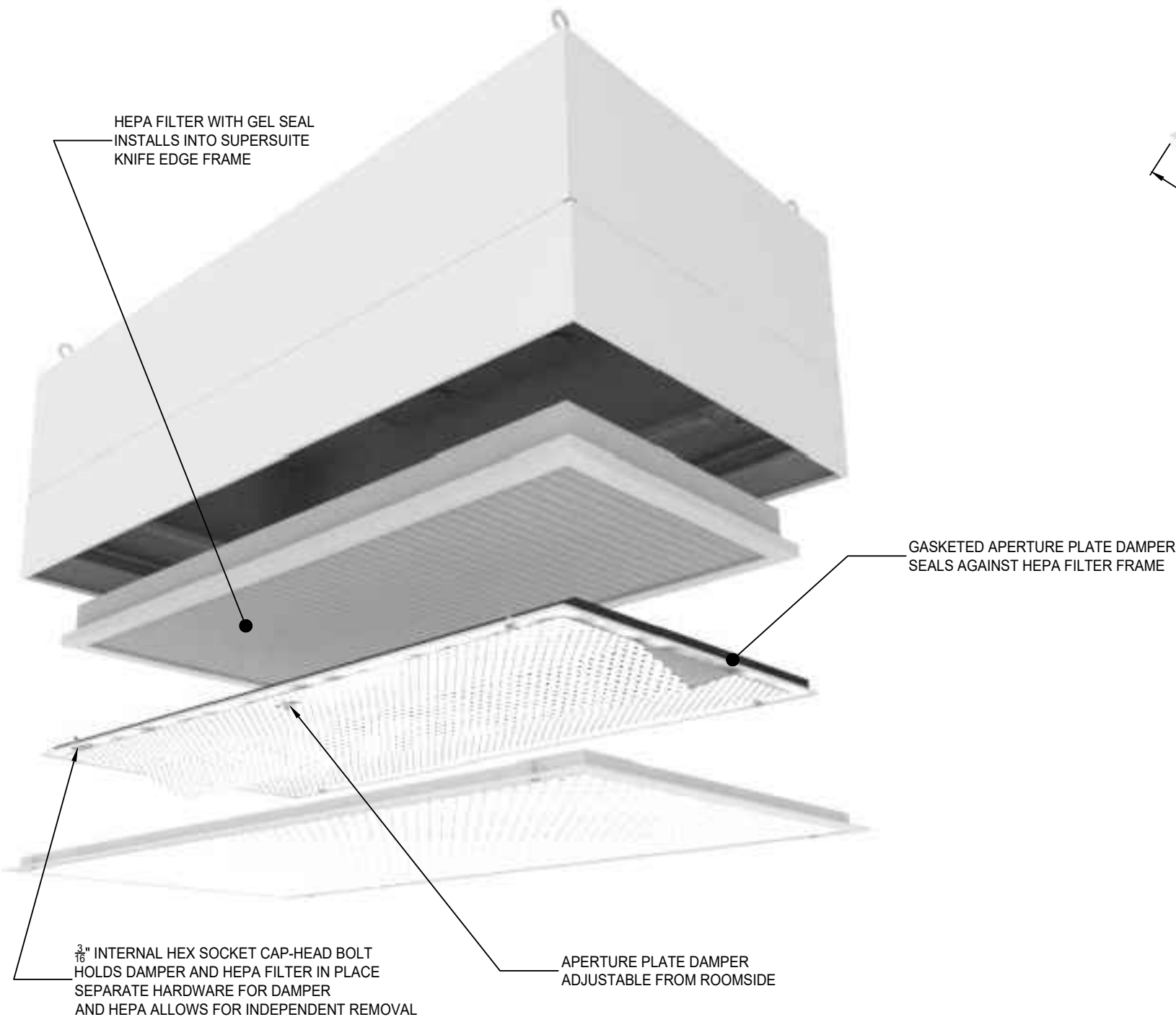

STANDARD FILTER SIZING CHART				
REPLACEMENT PART #	NOMINAL (W)	NOMINAL (L)	ACTUAL (W)	ACTUAL (L)
042299-029	24	24	19.88	19.88
042299-030	24	36	19.88	32.01
042299-032	24	48	19.88	44.13

- NOTES:**
- FILTER PLEATS RUN PARALLEL TO THE WIDTH (W) DIMENSION
  - DIMENSIONS W & L TOLERANCES  $\pm \frac{1}{16}$ "
  - FILTERS COME WITH GEL SEAL FILLED CHANNEL
  - FILTERS MUST BE ORDERED SEPARATELY UNDER THE VANGUARD-1-X LINESTRING
- FRAME DETAILS:**
- MATERIAL: ANODIZED EXTRUDED ALUMINUM
  - THICKNESS:  $\frac{1}{16}$ " (MINIMUM)
  - FILTERS ARE UL 900 CLASS 1 CERTIFIED
  - EFFICIENCY AND LEAK SCAN TESTED
  - HEPA EFFICIENCY: 99.99% (.3 MICRON)
  - MINIMUM MODULE WIDTH FOR ROOMSIDE HEPA FILTRATION IS 12"

**SUPERSUITE**  
by **PRICE**

Project:

274977

Revision: B

08-01-2023

VISIT KEYSTONE WEBSITE FOR FILTER QUICK START GUIDE  
<https://keystonecleanair.com/home/products/>  
NOTE:  
UL 1598 DOES NOT HAVE PROVISIONS FOR HEPA FILTERS MOUNTED WITHIN FIXTURE. SSA COMPLIES WITH UL 1598 WITH HEPA FILTERS ORDERED SEPERATELY ON VANGUARD-1-X LINESTRING.

# SUPERSUITE

## OPERATING ROOM DIFFUSER SYSTEM WITH INTEGRATED LED LIGHTING

### FACE ACCESS APERTURE PLATE DAMPER DETAILS

- OPTIONAL ROOMSIDE HEPA FILTRATION

### FILTER HOLD DOWN TAB DETAIL

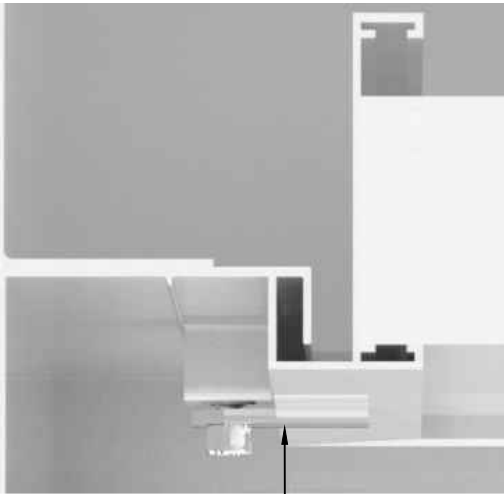

OPTIONAL  
FILTER HOLD  
DOWN TAB

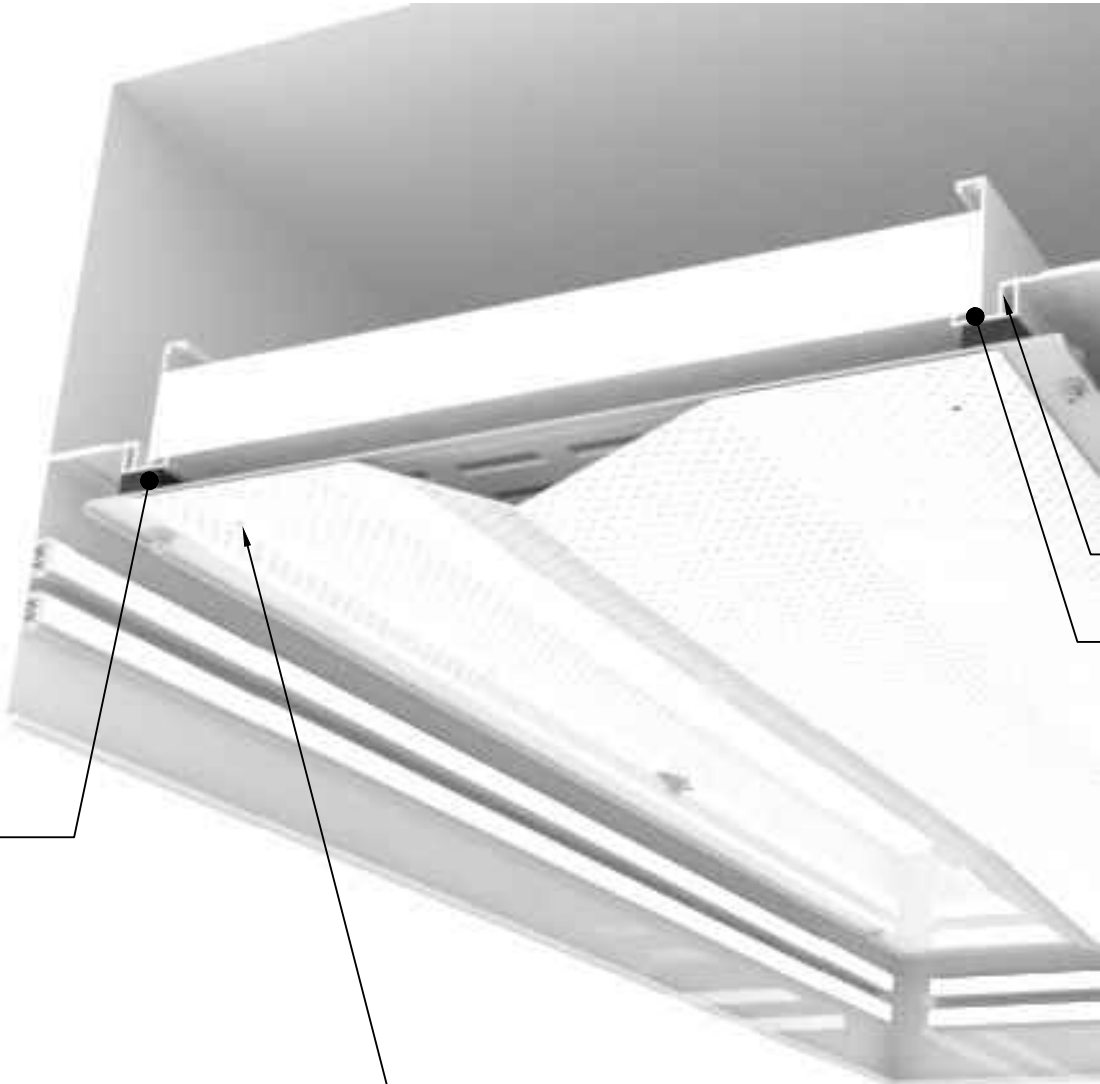

APERTURE PLATE  
DAMPER WITH UL2043  
RATED GASKET  
SEALS AGAINST  
THE KNIFE EDGE

DAMPER SECURED  
IN PLACE WITH SCREWS  
INSTALL BY USING  $\frac{3}{16}$ " ALLEN KEY

KNIFE EDGE  
HEPA FILTER  
GEL SEAL

### STATIC PRESSURE PORT DETAIL

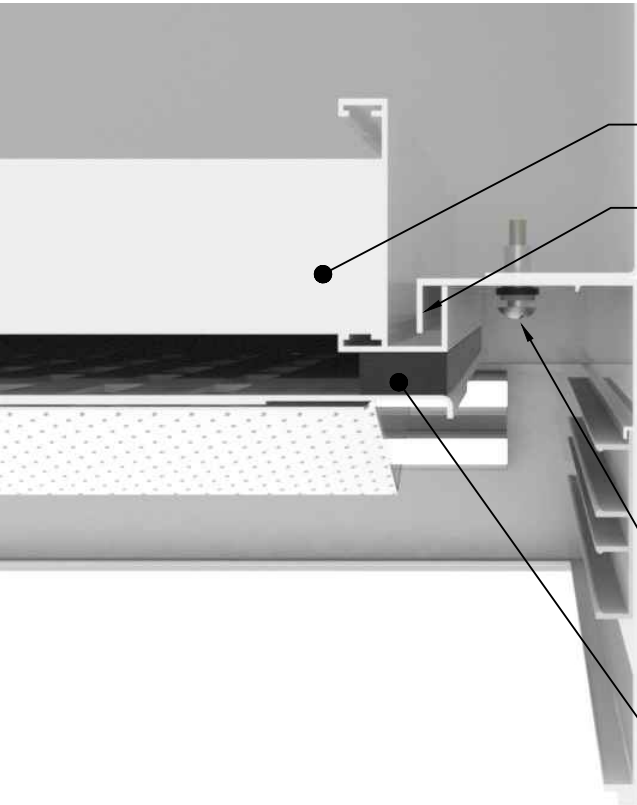

OPTIONAL  
HEPA FILTER  
KNIFE EDGE

STATIC  
PRESSURE  
PORT

APERTURE PLATE  
DAMPER WITH UL2043  
RATED GASKET  
SEALS AGAINST  
THE HEPA FRAME

**SUPERSUITE**  
by **PRICE**

Project:

274977

Revision: B

08-01-2023



# SUPERSUITE

## OPERATING ROOM DIFFUSER SYSTEM WITH INTEGRATED LED LIGHTING SRDC SUPER REMOTE DRIVER CABINETS - STANDARD OFFERINGS

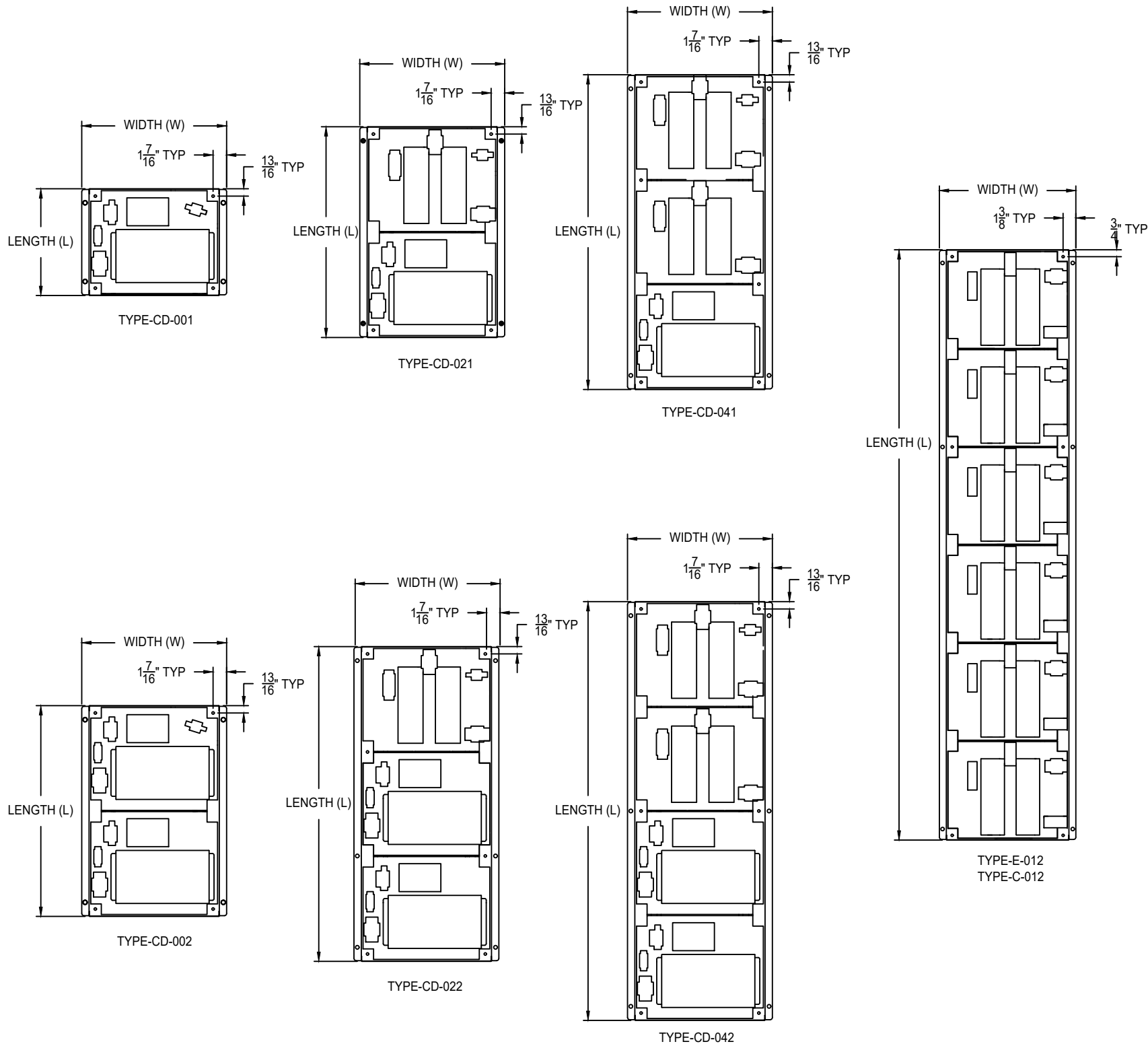

- ALL DRIVER CABINETS ARE ORDERED ON SRDC-1-X LINESTRING.
- REMOTE DRIVER CABINETS REQUIRE SINGLE POINT HIGH VOLTAGE (120-277v~) CONNECTION (277V~ RECOMMENDED).
- ALL DIMMING SWITCHES ARE ORDERED ON SCA-1-X LINESTRING.
- 0-10V DIMMING SWITCH SHIPPED LOOSE. THE TOTAL LENGTH FOR 0-10V CONTROL SIGNAL WIRING FOR THIS CONTROL SHOULD NOT EXCEED 500'. DO NOT USE WIRE SMALLER THAN 20 AWG.
- 8A AND 16A 0-10V DIMMING SWITCHES AVAILABLE. DIMMING ZONES AND CONTROL ARE COMPLETELY CUSTOMIZABLE.
- 0-10V DIMMING SIGNAL FROM SWITCH CAN CONTROL UP TO 100 DRIVERS.
- LED DRIVER TYPE E OFFERS CONTINUOUS, FLICKER-FREE DIMMING FROM 100% TO 1% WITH 0-10 VOLTAGE DIMMER SHIPPED LOOSE OR DIMMING SIGNAL PROVIDED BY OTHERS.
- LED DRIVER TYPE C AND CD OFFERS CONTINUOUS, FLICKER-FREE DIMMING FROM 100% TO 10% WITH 0-10 VOLTAGE DIMMER SHIPPED LOOSE. OPTIONAL SOLID STATE RELAY WITH 4-32VDC RELAY SHUT OFF SIGNAL AND 0-10VDC DIMMING SIGNAL PROVIDED BY OTHERS
- 30A DISCONNECT SWITCH AVAILABLE TO PROVIDE FULL SYSTEM SHUTOFF WHEN UTILIZING 0-10V SIGNAL
- LED DRIVERS SHIP FACTORY WIRED AND INSTALLED IN REMOTE DRIVER CABINETS.
- SRDC DRIVER CABINETS CAN BE WALL MOUNTED, TYPICALLY IN AN ADJACENT EQUIPMENT ROOM, OR INSTALLED ABOVE THE CEILING. DRIVER CABINETS CANNOT BE RECESSED BETWEEN WALL STUDS AS THEY REQUIRE VENTILATION.
- SUPERSUITE MODULES COME WITH FACTORY WIRED AND INSTALLED TOP MOUNTED LOW VOLTAGE TERMINAL BLOCK ENCLOSURE
- INCOMING HIGH VOLTAGE POWER AND LOW VOLTAGE CONNECTION BETWEEN SUPERSUITE MODULES AND REMOTE DRIVER CABINET ARE THE RESPONSIBILITY OF THE INSTALLER.
- MAX DISTANCE BETWEEN SUPERUITE MODULE AND REMOTE DRIVER CABINET IS DEPENDANT ON WIRE GAUGE TO MINIMIZE VOLTAGE DROP. SEE TABLE BELOW.
- SEE SUPERSUITE INSTALLATION MANUAL AVAILABLE AT <https://keystonecleanair.com/supersuite/> FOR RECOMMENDED REMOTE DRIVER CABINET AND SUPERSUITE SYSTEM INSTALLATION.

DRIVER CABINET	# OF MODULES	# OF DRIVERS	L	W	H	WEIGHT	AC CURRENT - TYPE E (120VAC / 277VAC)	AC CURRENT - TYPE C (120VAC / 277VAC)
TYPE E/C-001	1	1	0'-11 1/2"	1' - 3 1/2"	5"	7 lbs.	0.95A / 0.4A	1.2A / 0.50A
TYPE E/C-002		2	0'-11 1/2"	1' - 3 1/2"	5"	15 lbs.	1.9A / 0.8A	2.4A / 1.7A
TYPE E/C-003	2	3	1' - 10 9/16"	1' - 3 1/2"	5"	22 lbs.	2.95A / 1.2A	3.6A / 2.9A
TYPE E/C-004		4	1' - 10 9/16"	1' - 3 1/2"	5"	30 lbs.	3.8A / 1.6A	4.8A / 4.1A
TYPE E/C-005	3	5	2' - 9 11/16"	1' - 3 1/2"	5"	37 lbs.	4.75A / 2A	6.0A / 5.3A
TYPE E/C-006		6	2' - 9 11/16"	1' - 3 1/2"	5"	45 lbs.	5.7A / 2.4A	7.2A / 6.5A
TYPE E/C-007	4	7	3' - 8 13/16"	1' - 3 1/2"	5"	52 lbs.	6.65A / 2.8A	8.4A / 7.7A
TYPE E/C-008		8	3' - 8 13/16"	1' - 3 1/2"	5"	60 lbs.	7.6A / 3.2A	9.6A / 8.9A
TYPE E/C-009	5	9	4' - 7 15/16"	1' - 3 1/2"	5"	67 lbs.	8.55A / 3.6A	10.8A / 10.1A
TYPE E/C-010		10	4' - 7 15/16"	1' - 3 1/2"	5"	75 lbs.	9.5A / 4A	12.0A / 11.3A
TYPE E/C-011	6	11	5' - 7 1/16"	1' - 3 1/2"	5"	82 lbs.	10.45A / 4.4A	13.2A / 12.5A
TYPE E/C-012		12	5' - 7 1/16"	1' - 3 1/2"	5"	90 lbs.	11.4A / 4.8A	14.4A / 13.7A

DRIVER CABINET	# OF MODULES	# OF DRIVERS	L	W	H	WEIGHT	AC CURRENT - TYPE E (120VAC / 277VAC)
TYPE-CD-001	3	1	0'-11 1/2"	1' - 3 1/2"	5"	20 lbs.	7A / 2.9A
TYPE-CD-021	4	3	1' - 10 9/16"	1' - 3 1/2"	5"	35 lbs.	9.4A / 3.9A
TYPE-CD-041	5	5	2' - 9 11/16"	1' - 3 1/2"	5"	50 lbs.	11.8A / 4.9A
TYPE-CD-002	6	2	1' - 10 9/16"	1' - 3 1/2"	5"	40 lbs.	14.0A / 5.8A
TYPE-CD-022	7	4	2' - 9 11/16"	1' - 3 1/2"	5"	55 lbs.	- / 6.8A
TYPE-CD-042	8	6	3' - 8 13/16"	1' - 3 1/2"	5"	70 lbs.	- / 7.8A

LOW VOLTAGE WIRE LENGTHS	
WIRE GAUGE (awg)	LENGTH OF WIRE
18	15
16	25
14	45
12	70
10	115

- TYPE C & CD OFFERS 100 TO 10% DIMMING
- TYPE E OFFERS 100 TO 1% DIMMING
- TYPE CD OFFERS OVER 40% SPACE SAVING FOR CABINET INSTALLATION
- TYPE C ALLOWS FOR RECESSED TYPE IC INSTALLATION
- TYPE E & CD ALLOWS FOR SURFACE, WALL OR CEILING MOUNT INSTALLATION. PASSIVE VENTILATION OF CABINET IS REQUIRED THROUGH OUTER BOX LOUVERS

**SUPERSUITE**  
by **PRICE**

Project:

274977

Revision: B

08-01-2023

# SUPERSUITE

## OPERATING ROOM DIFFUSER SYSTEM WITH INTEGRATED LED LIGHTING

### ○ SRDC SUPER REMOTE DRIVER CABINETS - WIRING FOR SINGLE DIMMING ZONE (100 TO 1% DIMMING)

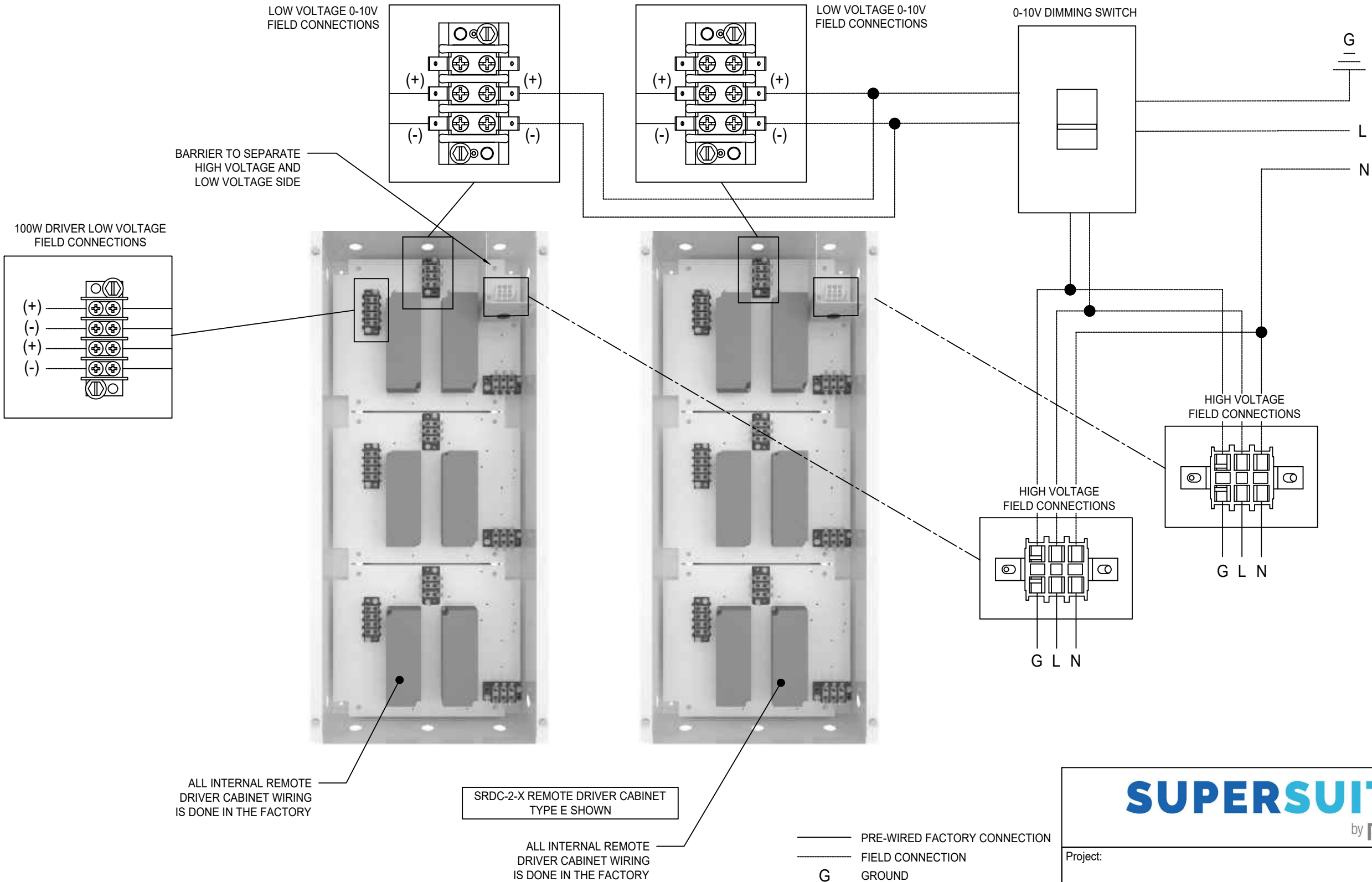

- VISUAL WIRING DETAIL IS SHOWN FOR REFERENCE ONLY, REFERENCE INSTALLATION MANUAL FOR WIRING DIAGRAMS
- INSTALLATION WORK AND ELECTRICAL WIRING MUST BE COMPLETED BY A CERTIFIED ELECTRICIAN AND/OR QUALIFIED PERSON(S) IN ACCORDANCE WITH APPLICABLE ELECTRICAL CODES AND STANDARDS

**SUPERSUITE**  
by **price**

Project:

274977

Revision: B

08-01-2023

# SUPERSUITE

## OPERATING ROOM DIFFUSER SYSTEM WITH INTEGRATED LED LIGHTING APEX INTEGRATION DETAILS

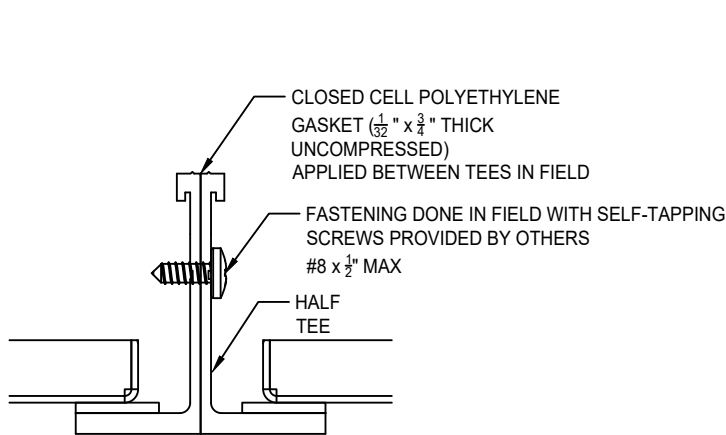

**A** HALF TEE FIELD JOINT

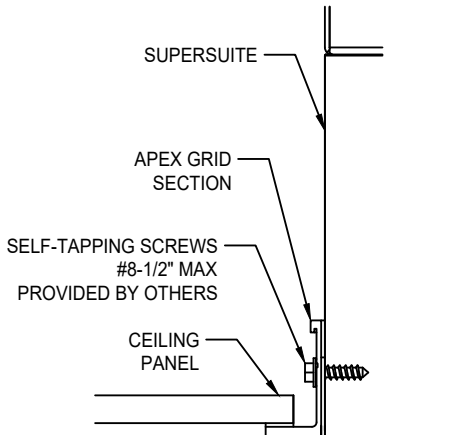

**C** APEX GRID INTEGRATION

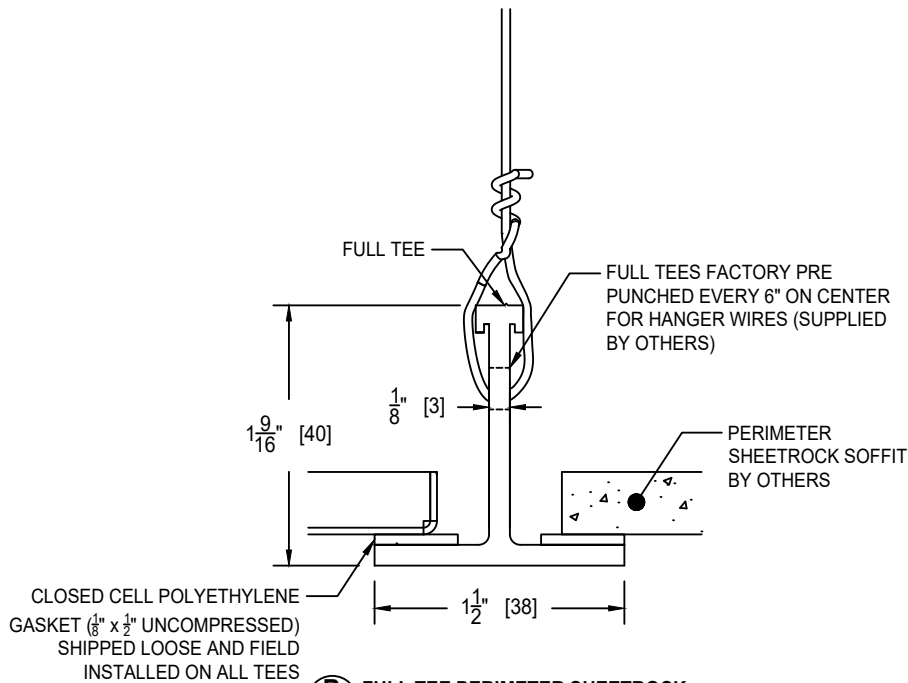

**B** FULL TEE PERIMETER SHEETROCK SOFFIT DETAIL

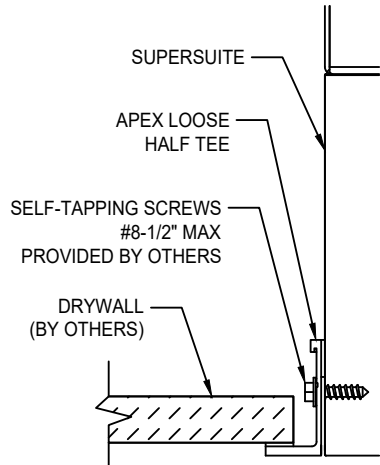

**D** PERIMETER HALF TEE INTEGRATION

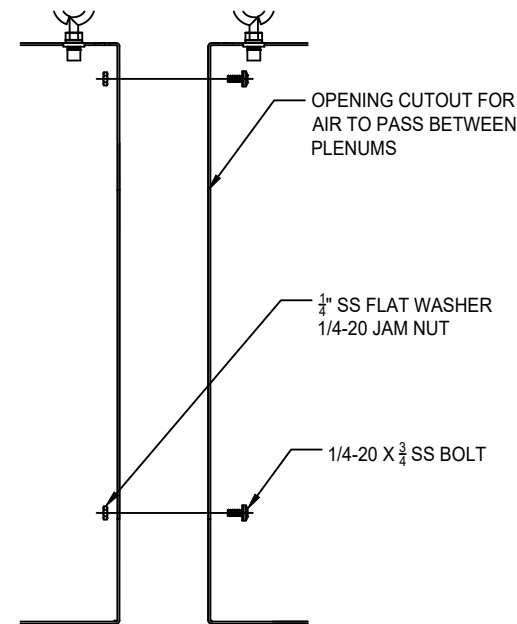

**E** BOLTED JOINT ASSEMBLY

**SUPERSUITE**  
by **PRICE**

Project:

274977

Revision: B

08-01-2023



# SUPERSUITE

## HOSPITAL GRADE WELDED CEILING SYSTEM CEILING PANELS

### SC - SOLID CORE

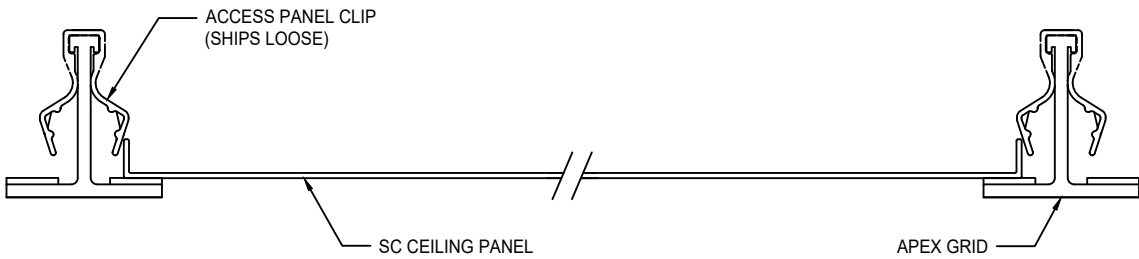
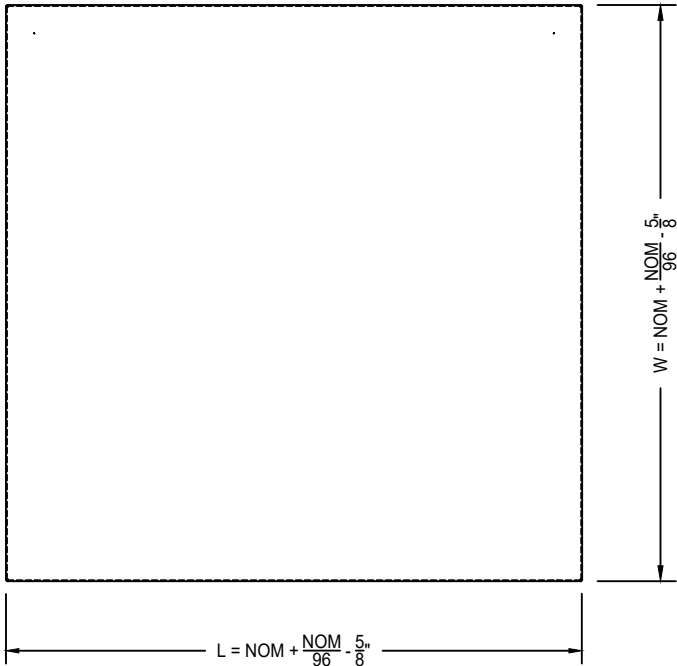

### SCF - SOLID CORE WITH FLUSH MOUNT FRAME

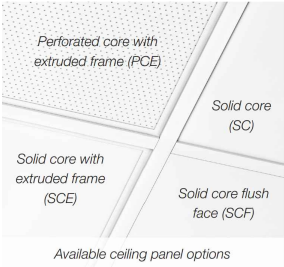
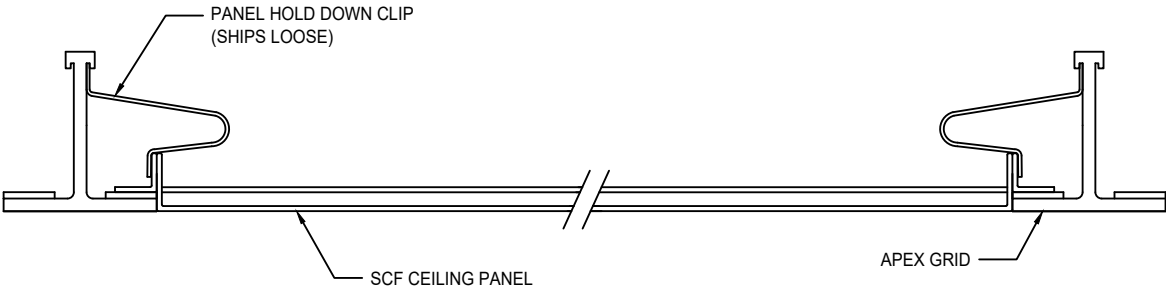
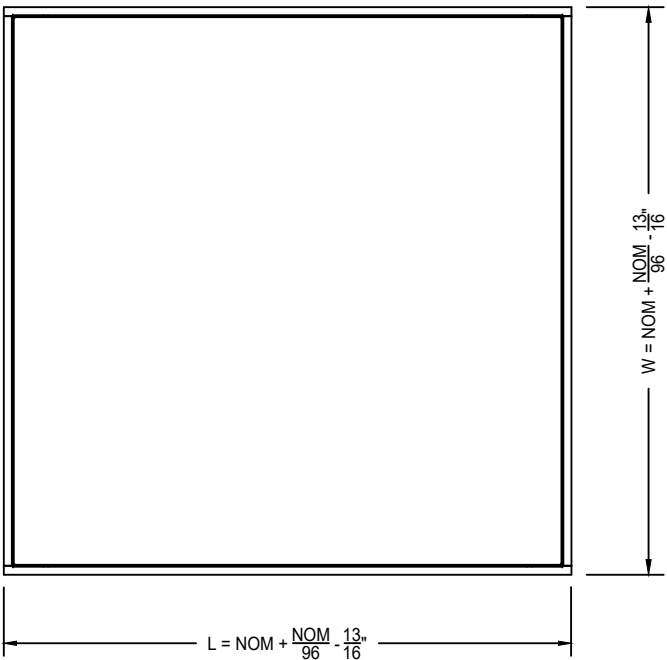

#### PANEL MATERIAL / FINISH:

- SC PANEL - .080" ALUMINUM / B12 STANDARD WHITE
- SCF PANEL - .040" ALUMINUM / B12 STANDARD WHITE

#### CEILING TYPE:

- APEX - 1 1/2" HOSPITAL GRADE WELDED CEILING SYSTEM

**SUPERSUITE**  
by **price**

Project:

274977

Revision: B

08-01-2023

# SUPERSUITE

## OPERATING ROOM DIFFUSER SYSTEM WITH INTEGRATED LED LIGHTING SUPPORTING CONTENT

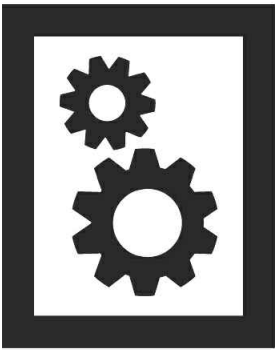

### MANUALS

- SSA SUPERSUITE MANUAL
- VANGUARD ROOM-SIDE REPLACEABLE FILTER (RSR) QUICK START GUIDE
- SRDC SUPER DRIVER CABINET MANUAL
- SCA SUPER COMPONENTS AND ACCESSORIES MANUAL
- APEX WELDED CEILING SYSTEM MANUAL

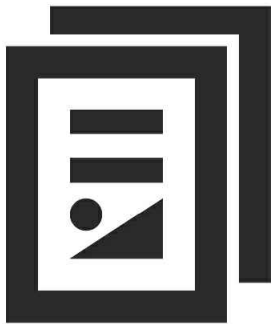

### CATALOG / PERFORMANCE

- SSA SUPERSUITE CATALOG
- SSA SUPERSUITE PERFORMANCE

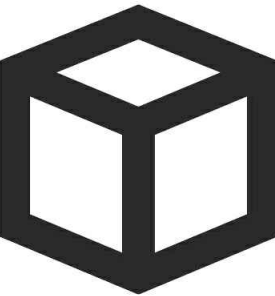

### REVIT FILES

- SSA TRADITIONAL OR REVIT FILE



### SUBMITTALS

- VANGUARD REPLACEMENT FILTER SUBMITTAL
- APEX WELDED CEILING SYSTEM SUBMITTAL

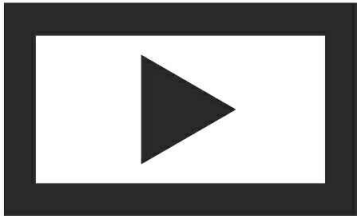

### VIDEOS

- SSA SUPERSUITE LAUNCH VIDEO
- SSA SUPERSUITE INSTALLATION TIME LAPSE VIDEO
- SSA SUPERSUITE SMOKE TEST VIDEO



FOR MORE INFORMATION ON KEYSTONE SUPERSUITE SYSTEMS, VISIT  
KEYSTONECLEANAIR.COM

**SUPERSUITE**  
by **PRICE**

Project:

274977

Revision: B

08-01-2023